

ROOM NUMBER	ROOM NAME	CEILING HEIGHT
100	GENERAL SALES	11'-2"
101	ENT. VESTIBULE	11'-2"
102	FITTING ROOM	11'-2"
103	STOCK ROOM	11'-2"
104	CORRIDOR	9'-0"
105	MALE RESTROOM	9'-0"
106	FEMALE RESTROOM	9'-0"
107	JANITOR	9'-0"
107A	OFFICE SUPPLIES	9'-0"
108	CASH/AUDIT	9'-0"
109	MARKING/RECEIVING	9'-0"
110	ASSOC. ENTRANCE	9'-0"
111	CONFER. ROOM	9'-0"
112	ASSOC. LOUNGE	9'-0"
113	ASM UTILITY	9'-0"
114	CORRIDOR	9'-0"
115	MANAGER OFFICE	9'-0"
116	COPIER/MAIL	9'-0"
117	TELE-COMMUN.	9'-0"
118	SWITCHGEAR	9'-0"
119	FITTING ROOM	11'-2"
120	STOCK	11'-2"
121	SPRINKLER/ELEC.	11'-2"
122	FITTING ROOMS	11'-2"
123	CORRIDOR	11'-2"
124	STOCK	11'-2"
125	CORRIDOR	11'-2"
126	STOCK	11'-2"
127	ELECTRICAL ROOM	11'-2"
128	STOCK	11'-2"
129	STOCK	11'-2"
130	CORRIDOR	11'-2"
131	FITTING ROOMS	11'-2"
132	FITTING ROOMS	11'-2"
133	STOCK	11'-2"
134	STOCK	11'-2"
135	STOCK	11'-2"
136	FITTING ROOMS	11'-2"

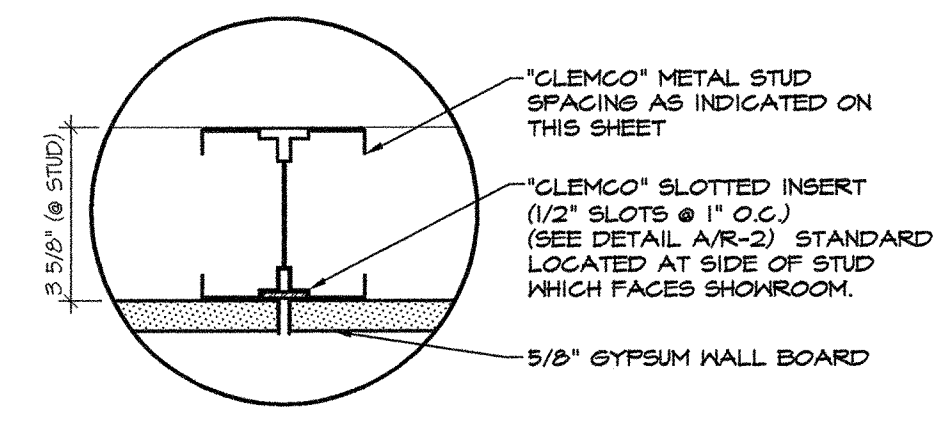

A
SCALE: 3/4\"/>

NOTES:

- WALL STANDARD DIMENSIONS SHOWN ON THIS SHEET ARE TO COORDINATE WITH THE STUDWALL DIMENSION PLAN (SHEET R-1). S.C. SHALL INFORM BELK INTERIOR JOB CAPTAIN OF ANY WALL LENGTH OR STUD SPACING DISCREPANCIES.
- REFER TO STUDWALL DETAIL SHEET R-2 FOR FURTHER INFORMATION. A/R-2 TYP. STUD ADAPTER DETAIL. L/R-2 TYP. SCHEMATIC INSERT SECTION.

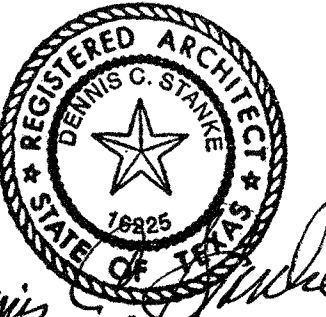

Expiration: 7/31/99
 Affixed: 2/17/99

RPDGC
 RETAIL PLANNING DESIGN GROUP
 ARCHITECTURE • INTERIOR PLANNING & DESIGN • CONSTRUCTION ADMINISTRATION FOR BELK STORES
 301 WEST TYBOLA ROAD • CHARLOTTE, NC • 28217-5508 • (704) 357-1084 • FAX (704) 357-8331

BELK STORES MALL
 1501 WEST TYBOLA ROAD
 CHARLOTTE, NC 28217

PARTIAL WALL STANDARD
 LOCATION PLAN

SHEET TITLE
 SHEET NUMBER
 DRAWN BY
 CHECKED BY
 DATE
 2-5-99

R-5B
 ARCHITECTURAL SHEET NUMBER
A-TB
 SHEETS