

CONTRACTOR(S) SHALL VERIFY EXISTING CONDITIONS AND CORRELATE DIMENSIONS PRIOR TO PROVIDING THE WORK DETAILED IN THESE DRAWINGS. AND SHALL PROMPTLY NOTIFY THE ARCHITECT OF ANY DISCREPANCIES.
 © COPYRIGHT SBLM, ARCHITECTS P.C. UNAUTHORIZED REPRODUCTION OR OTHER USE OF THIS DRAWING IS PROHIBITED.

PLUMBING FIXTURE SCHEDULE

TAG	DESCRIPTION	FIXTURE (SELECT ONE MFR)		TRIM (SELECT ONE MFR)		PIPE SIZES					SFU	DFU	REMARKS
		MANUFACTURER	MODEL	MFR	MODEL	TRAP	WASTE	VENT	CW	HW			
WC	WATER CLOSET PA TANK FLOOR MOUNTED	KOHLER AM STAND	K-3505-T 2462.016			4"	4"	2"	1/2"	--	5	6	WHITE VITREOUS CHINA, ELONGATED BOWL, PRESSURE ASSISTED SIPHON JET FLUSH ACTION, FLUSHOMETER TANK WITH FLUSH LEVER ON OPEN SIDE OF TOILET, METAL ACTUATOR (TRIP) ARM CHURCH #9500C OPEN FRONT SEAT W/O LID, 1.6 GALLON PER FLUSH. PROVIDE TANK LOCKING CLIPS.
WCA	WATER CLOSET PA TANK BARRIER FREE FLOOR MOUNTED	KOHLER AM STAND	K-3493-T 2467.016			4"	4"	2"	1/2"	--	5	6	WHITE VITREOUS CHINA, 17" HIGH ELONGATED BOWL, PRESSURE ASSISTED SIPHON JET FLUSH ACTION, FLUSHOMETER TANK WITH FLUSH LEVER ON OPEN SIDE OF TOILET, CHURCH #9500C OPEN FRONT SEAT W/O LID, 1.6 GALLON PER FLUSH, PROVIDE TANK LOCKING CLIPS.
UR	URINAL WALL HUNG	KOHLER AM STAND	K-4960-ET 6501.01	ZURN	Z-6003-WS1	2"	2"	2"	3/4"	--	5	4	WHITE VITREOUS CHINA, 3/4" TOP SPUD, 1.0 GALLON PER FLUSH, MOUNTED TO WALL WITH WALL HANGERS. MOUNT WITH RIM 17" AFF.
LV	COUNTERTOP WALL HUNG	AM STAND	321.026	CHICAGO FAUCETS	116.976.AB.1	2"	2"	2"	1/2"	1/2"	2	2	WHITE VITREOUS CHINA, 4" FAUCET CENTERS, OPEN GRID DRAIN STRAINER, FRONT OVERFLOW. SENSOR ACTIVATED ELECTRONIC FAUCET, SHELF SUSTAINING BATTERY POWERED WITH ASSE 1070 COMPLIANT BELOW DECK THERMOSTATIC MIXING VALVE AND PRESSURE COMPENSATING VANDAL PROOF 0.5 GPM SPRAY. TIMEOUT SETTING 30 SECONDS.
MS	MOP SINK	FIAT	MSB2424	FIAT	830 AA	2"	2"	2"	1/2"	1/2"	3	3	FIBERGLASS FLOOR SERVICE SINK, 3" DRAIN WITH OPEN GRID STRAINER, FAUCET WITH TOP BRACE, STOPS & VACUUM BREAKER. INSTALL FAUCET AT 36" ABOVE FINISH FLOOR AS PER INSTALLATION INSTRUCTIONS.
SK1	SINK-SINGLE COMPARTMENT 20 GAUGE	ELKAY	GECR-2521	CHICAGO FAUCET	116.943.AB.1	2"	2"	2"	1/2"	1/2"	4	2	25" LX21" W 5-3/8" D. TYPE 304 STAINLESS STEEL. 3-1/2" DRAIN OPENING. PROVIDE SENSOR ACTIVATED ELECTRONIC FAUCET WITH TEMPERATURE CONTROL, BATTERY POWERED WITH SELF SUSTAINING POWER SYSTEM WITH ASSE 1070 COMPLIANT BELOW DECK THERMOSTATIC MIXING VALVE AND PRESSURE COMPENSATING VANDAL PROOF 1.5 GPM SPRAY. TIMEOUT SETTING OF 30 SECONDS.
SK2	WORK ROOM SINK STAINLESS STEEL	ELKAY	SS-8124-(L OR R)	CHICAGO FAUCET	116.943.AB.1	2"	2"	2"	1/2"	1/2"	3	2	STURDIBUILT TYPE 304 STAINLESS STEEL WITH 24" DRAIN BOARD, 8" BACKSPASH, SQUARE CORNER CONSTRUCTION, #LK-18B GRID STRAINER W/ TAILPIECE, FOUR TUBULAR STEEL LEGS. *VERIFY DRAIN BOARD SIDE (LEFT OR RIGHT) W/ FLOOR PLAN. PROVIDE 1.6 GPM FLOW RESTRICTOR.
SK3	SINK COUNTERTOP STAINLESS STEEL	ELKAY	D11515	CHICAGO FAUCET	116.943.AB.1	2"	2"	2"	1/2"	1/2"	2	2	SELF RIMMING STAINLESS STEEL HOSPITALITY SINK, SINGLE HOLE, OPEN GRID DRAIN STRAINER. PROVIDE SENSOR ACTIVATED ELECTRONIC FAUCET, W/ TEMPERATURE CONTROL BATTERY POWERED WITH SELF SUSTAINING POWER SYSTEM WITH ASSE 1070 COMPLIANT BELOW DECK THERMOSTATIC MIXING VALVE AND PRESSURE COMPENSATING VANDAL PROOF 1.5 GPM SPRAY. TIMEOUT SETTING OF 30 SECONDS.
EWC	ELECTRIC WATER COOLER BARRIER-FREE	ELKAY HAWS OASIS	EZSTL8C HWJACP8L P8ACSL			2"	2"	2"	1/2"	--	1/2	1	WALL MOUNTED BARRIER FREE, FRONT AND SIDE PUSH BARS, SINGLE UTILITY CONNECTION. HI-LO MODEL.
WMB	WASHING MACHINE OUTLET BOX	SIoux CHIEF	696-2313MF						3/4"	3/4"		4	ABS RECESSED OUTLET BOX. VALVES WITH 3/4" MALE HOSE-THREAD OUTLET, INTEGRAL WATER HAMMER ARRESTERS. WATER BOX ONLY WASTE BOX NOT USED.
WH	WATER HEATER GAS 60 GALLON W/ EXPANSION TANK	BRADFORD WHITE	EFPC-60T-125E-3N NO SUBSTITUTIONS	AMTROL	ST-12	--	--	--	1-1/2"	1-1/2"	--	--	94% EXTRA HIGH EFFICIENCY SEALED COMBUSTION WATER HEATER, ZERO CLEARANCE TO COMBUSTIBLES. PVC VENT AND COMBUSTION AIR INTAKE. PROVIDE WITH CONCENTRIC VENT TERMINAL KIT (196116) AND AMTROL EXPANSION TANK. 3/4" GAS CONNECTION. 145 GPH RECOVERY @ 100°F RISE. REQUIRED SOURCE FOR ORDERING THIS PACKAGE: HAINES JONES & CADBURY EMAIL: PETCO@HJINC.COM PHONE: 800-459-7099
SI	SOLIDS INTERCEPTOR	ZURN	Z-1180 NO SUBSTITUTIONS			--	2"	--	--	--	--	--	2" INLET AND OUTLET, REMOVABLE SEDIMENT BCKET.
FD	FLOOR DRAIN 5" ROUND NICKEL BRONZE	JAY R. SMITH WADE ZURN	2005-13-NB 110*STD5 ZN-415-B-P			2" OR 3"	2" OR 3"	2" OR 3"	--	--	--	3	DURA COATED CAST IRON BODY WITH BOTTOM OUTLET, COMBINATION INVERTIBLE MEMBRANE CLAMP & ADJUSTABLE COLLAR WITH TYPE B POLISHED NICKEL BRONZE STRAINER, POLISHED NICKLE BRONZE TOP, TRAP PRIMER FITTING. INSTALLED ELEVATION: EL [-0'-0"] (FLUSH)
FR1	FLOOR RECEPTOR 12.5"x12.5"x6"D NICKEL BRONZE	JAY R. SMITH	3141Y-19-SSM NO SUBSTITUTIONS			2" OR 3"	2" OR 3"	2" OR 3"	--	--	--	3	SQUARE INDIRECT WASTE DRAIN, CAST IRON BODY WITH A.R.E., NO HUB BOTTOM OUTLET, HINGED NICKEL BRONZE GRATE, AND SOLID BOTTOM PORTED SEDIMENT BUCKET WITH STAINLESS STEEL MESH SCREEN. INSTALLED ELEVATION: EL [-0'-1-1/2"]
FR2	FLOOR RECEPTOR 8"x8"x6"D	ZURN	FD2378			2" OR 3"	2" OR 3"	2" OR 3"	--	--	--	3	SQUARE INDIRECT WASTE DRAIN, CAST IRON BODY WITH ACID-RESISTING COATING AND PVC ANTI-SPLASH DOME STRAINER. NO GRATE. INSTALLED ELEVATION: EL [-0'-0"] (FLUSH)
CP	RECIRCULATING PUMP	TACO	0014-SFI-IFC										STAINLESS STEEL 10 GPM @ 16, 120V, 1 PH, CONTROLLED BY HONEYWELL SURFACE MOUNT L6006C AQUASTAT SET @ 110 DEGREES FARENHEIT.
TV1	TEMPERING VALVE	POWERS	LFMM431-1			--	--	--	3/4"	3/4"	--	--	TEMPERING VALVE FOR 110 DEG. WATER. ASSE 1017 COMPLIANT. CAPABLE OF 20 GPM WITH 10 PSI PRESSURE DROP.
TV2	AQUARIUM TEMPERING VALVE	SYMMONS	7-230-CK-M			--	--	--	3/4"	3/4"	--	--	AQUARIUM FILTRATION SYSTEM TEMPERING VALVE. SET VALVE AT 75 DEG
HB	HOSE BIBB FREEZEPROOF ROOF MOUNTED	JAY R. SMITH PRIER ZURN	5907 P-RH2 Z1388			--	1/2"	--	3/4"	--	--	--	FREEZEPROOF KEY ROOF HYDRANT ENSURE MODEL PROVIDED IS LOCKABLE
FHB	HOSE BIBB FREEZEPROOF	JAY R. SMITH WADE ZURN	55090T 8600L175 Z1320-C-WC			--	--	--	3/4"	--	--	--	RECESSED FREEZEPROOF KEY-OPERATED WALL HYDRANT
TM1	DIGITAL THERMOMETER	DIGI-STEM	DSTP400K D1399-01			--	--	--	--	--	--	--	DIGI-STEM DST400K BATTERY POWERED DISPLAY WITH D1399-01 REMOTE PROBE. COORDINATE WITH PETCO PM FOR EXACT INSTALLATION LOCATION OF DISPLAY ABOVE COUNTER. CONTACT SALES@PALMERWAHL.COM OR (800) 421-2853 EX 321 FOR ORDERING.
TM2	THERMOMETER	WEISS	9VU35			--	--	--	--	--	--	--	INDUSTRIAL GLASS THERMOMETER.

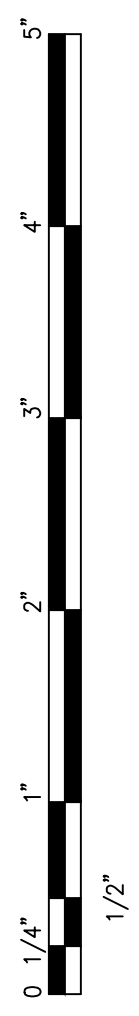

PLUMBING GENERAL NOTES

- COORDINATE LOCATIONS OF ALL PLUMBING PIPING AND SPRINKLER PIPING TO CLEAR INTAKE LOUVERS. PROVIDE 10'-0" CLEARANCE IN ALL DIRECTIONS FROM VENTS THROUGH ROOF TO OUTSIDE AIR INTAKES.
- THE FLOOR PLANS AND RISERS DO NOT SHOW ALL VALVES. PROVIDE ISOLATION VALVES AT ALL FIXTURES AND VALVES FOR EACH WATER PIPE SUPPLYING A FIXTURE GROUP (E.G. TOILET ROOM, GROOMING AREA, ETC.) FOR EASE OF SERVICE AND MAINTENANCE. PROVIDE ISOLATION VALVE ON EACH UNDERSLAB PIPE BRANCH, AQUARIUM GROUP, AND AT EACH SIDE OF VENDOR-SUPPLIED EQUIPMENT. DO NOT LOCATE ISOLATION VALVES ABOVE HARD CEILINGS.
- MAINTAIN MINIMUM 10'-0" BETWEEN OUTSIDE AIR INTAKES AND ANY EXHAUST OUTLET OR PLUMBING VENT.
- PROVIDE SCALD GUARD ON ALL TRAPS AND HOT WATER SUPPLIES OF SINKS AND LAVATORIES WHERE EXPOSED TO OPEN KNEE SPACE.
- REFER TO ARCHITECTURAL PLANS AND PROJECT MANUAL FOR TRENCHING DETAILS AND SLAB REPAIRS.
- WHERE DEMOLITION IS REQUIRED, CAP OFF WATER AND SANITARY PIPING MADE OBSOLETE. REMOVE ALL ABOVE SLAB PIPING, ABANDON ALL OBSOLETE UNDERSLAB PIPING. NO UNUSED PIPING SHALL REMAIN CONNECTED TO THE ACTIVE SYSTEM.
- COORDINATE ACTIVITIES WITH LOCAL UTILITIES (WATER, SEWER, GAS) AND SHALL INCLUDE ALL UTILITY REQUIREMENTS INCLUDING, BUT NOT LIMITED TO, MATERIALS, LABOR AND METERING CLEARANCES. CONTRACTOR SHALL SECURE, PAY AND SCHEDULE ALL REQUIRED PERMITS, FEES, AND REQUIRED INSPECTIONS.
- FOR WATER CLOSETS, SINKS, AND LAVATORIES, PROVIDE ALL NECESSARY SUPPLY AND DRAINAGE FITTINGS FOR CONNECTIONS TO BUILDING SYSTEMS. ON SUPPLY PIPING, PROVIDE WHEEL HANDLE STOPS OR 1/4"-TURN BALL VALVE - NO KEYED STOPS ARE PERMITTED.
- PROVIDE WATER HAMMER ARRESTORS AND TRAP PRIMERS AS PER LOCAL CODES AND AUTHORITIES HAVING JURISDICTION AND PER PLUMBING SPECIFICATIONS.
- WHERE EXPRESSLY PERMITTED (IN ADVANCE, IN WRITING) BY LOCAL AUTHORITIES, IN LIEU OF A MECHANICAL WATER DRIP TRAP PRIMER, A WATERLESS TRAP SEALER SUCH AS SURESEAL MODEL #SS3000 INLINE FLOOR DRAIN TRAP SEALER MAY BE USED.

HORIZONTAL PIPING SUPPORT

- HORIZONTAL PIPE OF THE FOLLOWING MATERIALS SHALL BE SUPPORTED ACCORDING TO THE MANUFACTURER'S RECOMMENDATIONS BUT NOT LESS THAN THE DISTANCES LISTED BELOW. NO PIPING IS TO BE SUPPORTED DIRECTLY FROM THE ROOF DECK.
- CAST IRON SOIL PIPE
 - FIVE FOOT (5') INTERVALS EXCEPT WHERE TEN FOOT (10') LENGTHS OF CAST IRON SOIL PIPE ARE USED. TEN FOOT (10') INTERVALS BETWEEN SUPPORTS ARE ACCEPTABLE.
- STEEL THREADED PIPE
 - 1-1/4" IN DIAMETER OR LESS - EIGHT FOOT (8') INTERVALS
 - 1-1/2" AND OVER - TEN FOOT (10') INTERVALS.
- COPPER TUBE
 - 1-1/4" OR LESS - SIX FOOT (6') INTERVALS.
 - 1-1/2" OR OVER - TEN FOOT (10') INTERVALS.
- PLASTIC (PVC AND ABS) PIPE
 - 1-1/2" OR LESS - THREE FOOT (3') INTERVALS.
 - 2" OR OVER - FOUR FOOT (4') INTERVALS.
- EXPOSED
 - ALL PIPING IN EXPOSED LOCATIONS TO ROUTE ALONG WALLS OR STRUCTURE.

PLUMBING SYMBOLS

IDENTIFIER	DESCRIPTION
	OS&Y GATE VALVE
	BALL VALVE WITH MEMORY STOP KIT
	CHECK VALVE
	BALANCING VALVE
	1/4" TURN BALL VALVE
	GAS COCK
	GAS PRESSURE REGULATOR
	GAS SOLENOID VALVE
	UNION
	CLEANOUT FLOOR MOUNTED
	CLEANOUT MOUNTED AT GRADE
	CLEANOUT IN WALL
	CLEANOUT DECK PLATE
	WATER METER
	GAS METER
	THERMOMETER
	WALL HYDRANT
	FLOOR DRAIN
	FLOOR RECEPTOR
	ROOF DRAIN
	OVERFLOW DRAIN
	EQUIPMENT DESIGNATION
	PLUMBING FIXTURE TAG
	VENT THROUGH ROOF
	DETAIL CALLOUT
	CONNECT TO EXISTING
	SANITARY SEWER PIPING BELOW FLOOR
	SANITARY SEWER PIPING
	CONDENSATE PIPING
	STORM SEWER PIPING BELOW FLOOR
	STORM SEWER PIPING
	VENT PIPING
	VENT PIPING BELOW FLOOR
	COLD WATER PIPING
	COLD WATER PIPING BELOW FLOOR
	HOT WATER PIPING
	HOT WATER PIPING BELOW FLOOR
	HOT WATER RECIRCULATING PIPING
	FILTERED WATER PIPING
	FILTERED WATER PIPING BELOW FLOOR
	GAS PIPING

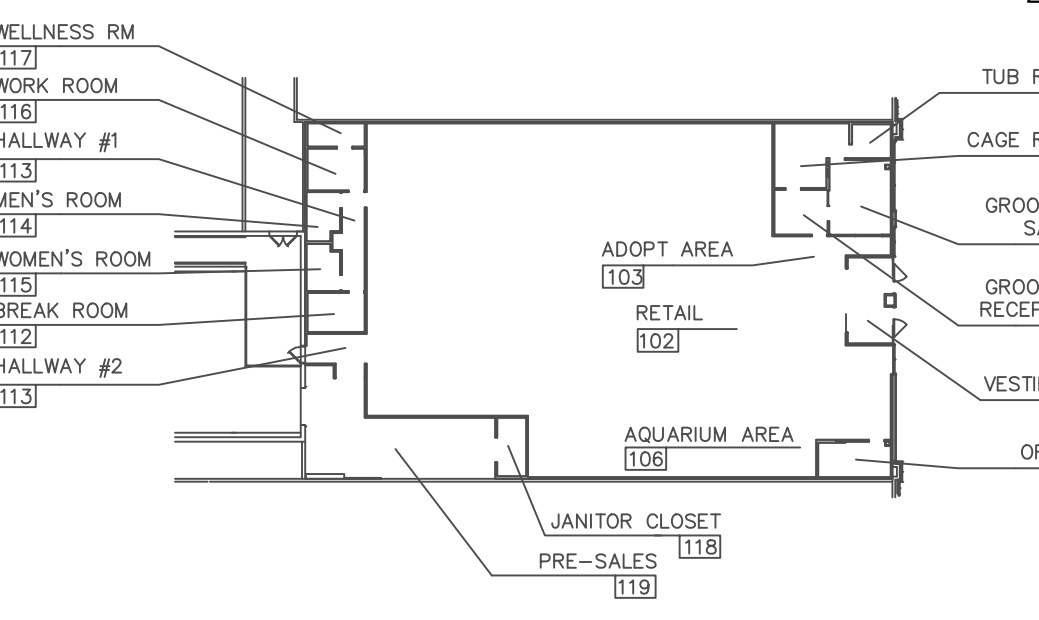

KEY PLAN
 REF.:
 01
 NO SCALE

ACERTUS CONSULTING GROUP, LLC
 14817 West 95th Street
 Lenexa, Kansas 66215
 P 913 322-5150 F 913 322-5155
 www.AcertusGroup.com
 Registered Engineering Firm
 E-11902

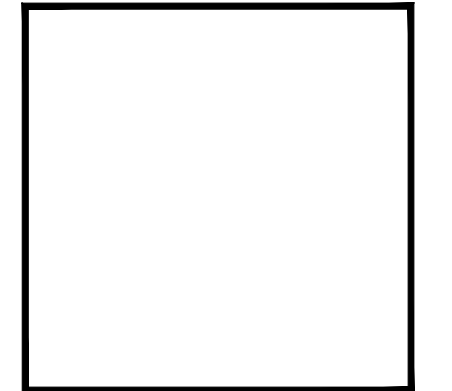

petco
 PETCO ANIMAL SUPPLIES STORES, INC.
 6834 WESLEY STREET
 GREENVILLE, TX 75402

DISTRIBUTION:	DATE:
25% SUBMISSION	06-28-11
75% SUBMISSION	08-11-11
98% SUBMISSION	08-16-11
100% SUBMISSION	09-23-11
PERMIT SET	09-28-11
FINAL PERMIT SET	09-20-13
BULLETIN #1	10-22-14

DRAWING TITLE:
 PLUMBING GENERAL INFORMATION AND SCHEDULES
P1.1