

CONTRACTOR(S) SHALL VERIFY EXISTING CONDITIONS AND CORRELATE DIMENSIONS PRIOR TO PROVIDING THE WORK DETAILED IN THESE DRAWINGS. AND SHALL PROMPTLY NOTIFY THE ARCHITECT OF ANY DISCREPANCIES.
 © COPYRIGHT SBLM ARCHITECTS P.C. UNAUTHORIZED REPRODUCTION OR OTHER USE OF THIS DRAWING IS PROHIBITED.

ARCH. DWG. ABBREVIATIONS AND SYMBOLS			
&	AND	MDO	MEDIUM DENSITY OVERLAY
L	ANGLE	MECH.	MECHANICAL
⊙	AT	MEMB.	MEMBRANE
⊕	CENTERLINE	MET.	METAL
#	POUND OR NUMBER	MFR.	MANUFACTURER
ACT.	ACOUSTICAL CEILING TILE	MIN.	MINIMUM
ADJ.	ADJUSTABLE	MISC.	MISCELLANEOUS
AL.	ALUMINUM	M.O.	MASONRY OPENING
APPROX.	APPROXIMATE	M.R.	MOISTURE RESISTANT
ARCH.	ARCHITECTURAL	MTD.	MOUNTED
ASPH.	ASPHALT	N.I.C.	NOT IN CONTRACT
B.C.	BACK OF CURB	NO.	NUMBER
BD.	BOARD	NOM.	NOMINAL
BITUM.	BITUMINOUS	N.T.S.	NOT TO SCALE
BLDG.	BUILDING	O.A.	OVERALL
BLK.	BLOCK	OBS.	OBSOLETE
BM.	BEAM	O.C.	ON CENTER
B.O.	BOTTOM OF	O.D.	OUTSIDE DIMENSION
CAB.	CABINET	O.G.	OPAQUE GLAZING
CEM.	CEMENT	O.H.	OVERHANG
CER.	CERAMIC	OPNG.	OPENING
C.I.	CAST IRON	OPP.	OPPOSITE
C.F.	COLD FORMED	PRCST.	PRE-CAST
C.G.	CORNER GUARD	PL.	PLATE
C.J.	CONTROL JOINT	P. LAM.	PLASTIC LAMINATE
CLG.	CEILING	PLAS.	PLASTER
CLK.G.	CAULKING	PLUMB.	PLUMBING
CLR.	CLEAR	PLYWD.	PLYWOOD
CMU	CONCRETE MASONRY UNIT	P.O.C.	POINT OF CONNECTION
C.O.	CASED OPENING	PR.	PAIR
COL.	COLUMN	PR. TR.	PRESSURE TREATED
CONC.	CONCRETE	PT.	POINT
CONN.	CONNECTION	PTD.	PAINTED
CONST.	CONSTRUCTION	Q.T.	QUARRY TILE
CONT.	CONTINUOUS	R.	RISER
CORR.	CORRIDOR	RAD.	RADIUS
CTSK.	COUNTERSUNK	R.D.	ROOF DRAIN
CNTR.	COUNTER	REF.	REFERENCE
C.T.	CERAMIC TILE	REFR.	REFRIGERATOR
CTR.	CENTER	REINF.	REINFORCED
D	DEPTH	REQD.	REQUIRED
DBL.	DOUBLE	RESIL.	RESILIENT
DEPT.	DEPARTMENT	RET.	RETAINING
D.F.	DRAINING FOUNTAIN	RM.	ROOM
DET.	DETAIL	R.O.	ROUGH OPENING
DIA.	DIAMETER	R.T.U.	HYVAC UNIT
DIM.	DIMENSION	RWC	RAINWATER CONDUCTOR
DISP.	DISPENSER		
DN.	DOWN	S.C.	SOLID CORE
D.O.	DOOR OPENING	SCHED.	SCHEDULED
DR.	DOOR	SHT.	SHEET
DWR.	DRAWER	S.J.	SAWCUT JOINT
DWG.	DRAWING	SIM.	SIMILAR
EA.	EACH	SPEC.	SPECIFICATION
E.I.F.S.	EXTERIOR INSUL. & FINISH SYSTEM	SPEC'D.	SPECIFIED (SECTION)
E.J.	EXPANSION JOINT	S.S.T.	STAINLESS STEEL
EL.	ELEVATION	STD.	STANDARD
ELEC.	ELECTRICAL	STL.	STEEL
EMER.	EMERGENCY	STOR.	STORAGE
ENCL.	ENCLOSURE	STRUC.	STRUCTURAL
EQ.	EQUAL	SUSP.	SUSPENDED
EQPT.	EQUIPMENT	T.C.	TOP OF CURB
E.W.C.	ELECTRIC WATER COOLER	TEL.	TELEPHONE
EXST.	EXISTING	T&G	TONGUE AND GROOVE
EXPO.	EXPOSED	T.G.	TEMPERED GLASS
EXP.	EXPANSION	T.G.P.	TEMPERED PRIVACY GLASS
EXT.	EXTERIOR	T.G./SP.	TEMPERED SPANDREL GLASS
EXTR.	EXTRUDED	T.I.G.	TEMPERED INSULATING GLASS
FABR.	FABRICATOR / FABRICATED	THK.	THICK
F.C.	FURRING CHANNEL	T.O.	TOP OF
F.D.	FLOOR DRAIN	T.P.	TOP OF PAVEMENT
FDN.	FOUNDATION	TS	TUBE STEEL
F.S.	FLOOR SINK		
F.E.	FIRE EXTINGUISHER	T.W.	TOP OF WALL
F.E.C.	FIRE EXTINGUISHER CABINET	TYP.	TYPICAL
FIN.	FINISH	UNF.	UNFINISHED
FIXT.	FIXTURE	U.G.	UNDERGROUND
FL.	FLOOR	U.O.N.	UNLESS OTHERWISE NOTED
FLASH.	FLASHING	UR.	URINAL
FLUOR.	FLUORESCENT	VCT	VINYL COMPOSITION TILE
F.O.C.	FACE OF CONCRETE	VERT.	VERTICAL
F.O.F.	FACE OF FINISH	VEST.	VESTIBULE
F.O.M.	FACE OF MASONRY		
F.O.S.	FACE OF STUDS	W/	WITH
FRMG.	FRAMING	WO	WOOD
FRP.	FIBER GLASS REINFORCED POLYESTER	W/O	WITHOUT
FR. TR.	FIRE RETARDANT TREATED	WP	WATERPROOF
FT.	FOOT OR FEET	WNSCOT	WAINSCOT
FTG.	FOOTING	WSCT.	WEIGHT
FURR.	FURRING	WT.	WEIGHT
GA.	GALVANIZED		
GL.	GLASS	C.L.	COLUMN LINE
GR.	GRADE		
GYP.	GYPNUM		
GYP. BD.	GYPNUM WALLBOARD		
H.B.	HOSE BIBB		
H.C.	HOLLOW CORE		
H.D.	HEAVY DUTY		
HDWD	HARDWOOD		
HDWE	HARDWARE		
H.M.	HOLLOW METAL		
HORIZ.	HORIZONTAL		
HR.	HOUR		
HGT.	HEIGHT		
HSS.	HOLLOW STEEL SECTION		
I.D.	INSIDE DIMENSION		
I.G.	INSULATING GLASS		
INSUL.	INSULATION		
INT.	INTERIOR		
JAN.	JANITOR		
JT.	JOINT		
KIT.	KITCHEN		
L.	LENGTH		
LAM.	LAMINATE		
LAV.	LAVATORY		
L.T.	LIGHT		
MAX.	MAXIMUM		
MDF	MEDIUM DENSITY FIBERBOARD		

PROJECT TEAM	
LANDLORD:	Carl Esser 12300 N. Freeway #208 Houston, TX 77060 (281)673-1313
TENANT (OWNER IN FEE):	PETCO Animal Supplies Stores, Inc. 654 Richland Hills Drive San Antonio, TX 78245 Phone: (817) 581-6063 Fax: (858) 736-8169 Contact: John Sutton, Construction Manager Email: john.sutton@petco.com
ARCHITECT (TENANT IMPROVEMENT):	SBLM Architects 11430 North Kendall Drive, Suite 310 Miami, FL 33176 Phone: (305) 412-9187 Fax: (305) 412-6731 Contact: Freddy Renazzo, Job Captain Email: frenazzo@sblm.com
MECHANICAL/PLUMBING ELECTRICAL ENGINEER (TENANT IMPROVEMENT):	14817 West 95th Street Lenexa, KS 66215 Phone: (913) 322-5150 x 102 Fax: (913) 322-5155 Contact: Brian Timmons, PME Designer Email: brian.timmons@acertusgroup.com



TENANT IMPROVEMENT FOR
 A NEW PETCO STORE
 "GREENVILLE, TX"
 CORPORATE OFFICE: 654 RICHLAND HILLS DRIVE
 SAN ANTONIO, TX 78245

CODE DATA		
<ul style="list-style-type: none"> ● APPLICABLE CODES: BUILDING/STRUCTURAL CODE: 2006 INTERNATIONAL BUILDING CODE PLUMBING CODE: 2006 INTERNATIONAL PLUMBING CODE MECHANICAL CODE: 2006 INTERNATIONAL MECHANICAL CODE ELECTRICAL CODE: 2005 NATIONAL ELECTRICAL CODE ACCESSIBILITY CODE: 2006 INTERNATIONAL BUILDING CODE; ICC/ANSI 117.1-2003 FIRE AND LIFE SAFETY CODE: 2006 INTERNATIONAL FIRE CODE; NFPA 101 ENERGY CODE: 2006 INTERNATIONAL ENERGY CONSERVATION CODE 	<ul style="list-style-type: none"> ● Egress Width : M (Retail & Grooming) 311 X 0.15 in. = 46.65 in. 111.75 in. M (Stock) 2 X 0.15 in. = 0.30 in. - 313 46.95 in. 111.75 in. 	<ul style="list-style-type: none"> ● MINIMUM PLUMBING FIXTURES: MERCANTILE 313 PERSON
<ul style="list-style-type: none"> ● Group: M Mercantile 	<ul style="list-style-type: none"> ● Number of Exits: Group M (RETAIL, GROOMING, & STOCK) Required 2 Provided 2 	<ul style="list-style-type: none"> ● WATER CLOSETS 1 EA. SEX PER 500 PERSONS Male Female REQUIRED 1 1 PROVIDED 1 1
<ul style="list-style-type: none"> ● Building Shell Type of Construction: Type III-B, Unprotected 	<ul style="list-style-type: none"> ● ACCESSIBLE MEANS OF EGRESS REQUIRED: 2 PROVIDED: 2 	<ul style="list-style-type: none"> ● Lavatories 1 EA. SEX PER 750 PERSONS Male Female REQUIRED 1 1 PROVIDED 1 1
<ul style="list-style-type: none"> ● Allowable areas (with Fully Sprinklered System): Allowable Building Area: 50,000 SF Actual Building Area: M 10,051 SF 	<ul style="list-style-type: none"> ● Fire Separation Assembly Between Group M Tenants, with exception for Fully Sprinklered System: none 	<ul style="list-style-type: none"> ● Drinking Fountain 1 PER 1000 PERSONS Fixtures REQUIRED 1 PROVIDED 2
<ul style="list-style-type: none"> ● Exit Access Travel Distance (Table 1015.1): Required Provided With Sprinkler System 250'-0" See Plan 	<ul style="list-style-type: none"> ● Occupant Load (Table 1004.1.1): [Gross] M (Retail) 8,662 S.F. : 30 S.F./P.P. = 289 PERSONS M (Stock) 728 S.F. : 300 S.F./P.P. = 2 PERSONS M (Grooming) 661 S.F. : 30 S.F./P.P. = 22 PERSONS Occupant Load = 313 PERSONS 	<ul style="list-style-type: none"> ● SERVICE SINK REQUIRED 1 PROVIDED 1

SHEET	DRAWING TITLE	CURRENT ISSUE	DATE ISSUED
A0.1	Code Data, Project Data	BULLETIN 1	10/22/14
A0.2	PETCO Vendor / Contractor Furnished Items	BULLETIN 1	10/22/14
A1.2	Building Shell Verification Plan (Exhibit B)	BULLETIN 1	10/22/14
A2.1	Floor Plan and Partition Notes	BULLETIN 1	10/22/14
A2.2	Finish Plan and Schedule	BULLETIN 1	10/22/14
A2.3	Store Fixture Plan	BULLETIN 1	10/22/14
A2.4	Reflected Ceiling Plan	BULLETIN 1	10/22/14
A2.5	Roof Plan	BULLETIN 1	10/22/14
A3.1	Door Schedules, Door & Storefront Types	BULLETIN 1	10/22/14
A4.1	Exterior Elevations	BULLETIN 1	10/22/14
A5.1	Building Sections, Interior Wall Sections	BULLETIN 1	10/22/14
A5.2	Exterior Wall Sections	BULLETIN 1	10/22/14
A5.3	Exterior Wall Sections	BULLETIN 1	10/22/14
A5.4	Partition Types	BULLETIN 1	10/22/14
A5.5	Partition Types	BULLETIN 1	10/22/14
A6.1	Details	BULLETIN 1	10/22/14
A7.1	Large Scale Plans	BULLETIN 1	10/22/14
A8.1	Interior Details	BULLETIN 1	10/22/14
A8.2	Interior Details	BULLETIN 1	10/22/14
A8.3	Interior Details	BULLETIN 1	10/22/14
A9.1	Interior Elevations	BULLETIN 1	10/22/14
A9.2	Interior Elevations	BULLETIN 1	10/22/14
A9.3	Interior Elevations	BULLETIN 1	10/22/14

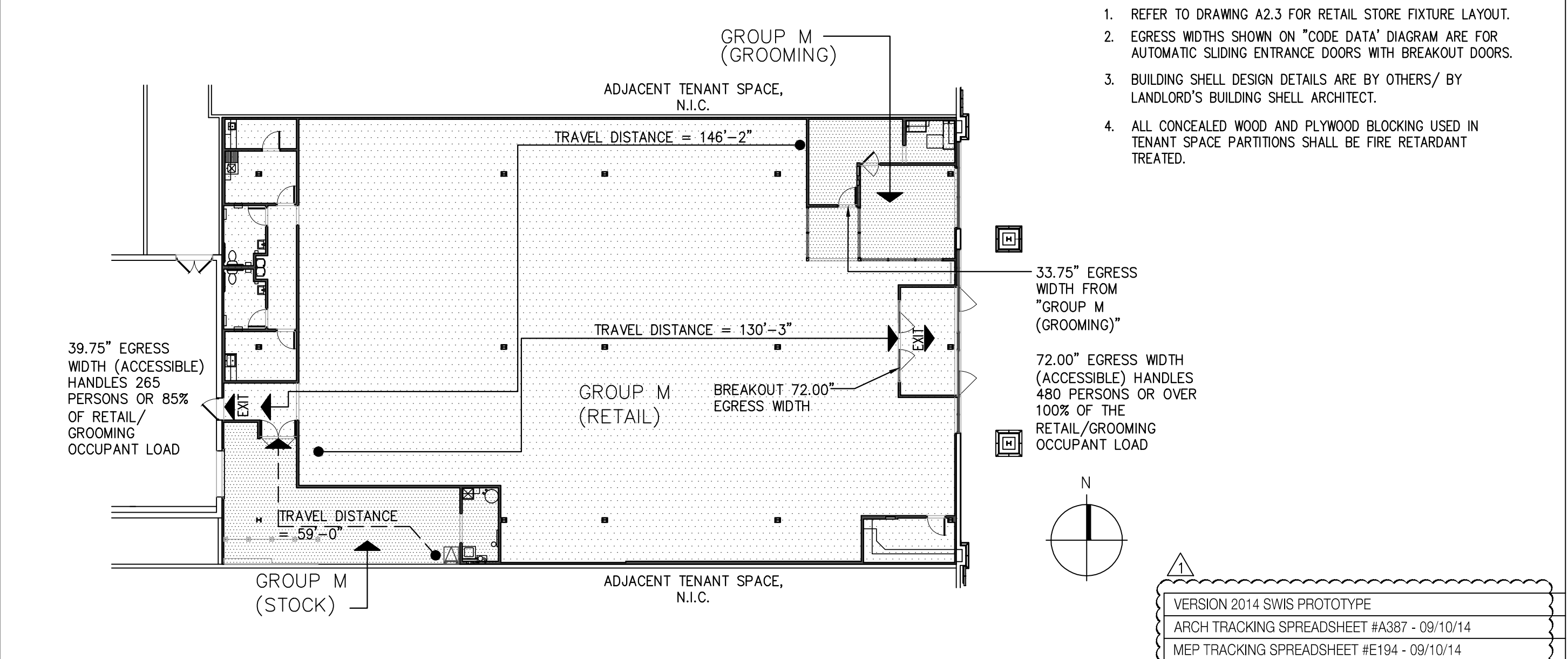

GENERAL NOTES REGARDING THIS PROJECT:

- REFER TO DRAWING A2.3 FOR RETAIL STORE FIXTURE LAYOUT.
- EGRESS WIDTHS SHOWN ON "CODE DATA" DIAGRAM ARE FOR AUTOMATIC SLIDING ENTRANCE DOORS WITH BREAKOUT DOORS.
- BUILDING SHELL DESIGN DETAILS ARE BY OTHERS/ BY LANDLORD'S BUILDING SHELL ARCHITECT.
- ALL CONCEALED WOOD AND PLYWOOD BLOCKING USED IN TENANT SPACE PARTITIONS SHALL BE FIRE RETARDANT TREATED.

PME1.1	Plumbing / Mechanical / Electrical General Information	BULLETIN 1	10/22/14
P1.1	Plumbing General Information & Schedules	BULLETIN 1	10/22/14
P2.1	Plumbing Plan	BULLETIN 1	10/22/14
P3.1	Sanitary Large Scale Plans & Details	BULLETIN 1	10/22/14
P3.2	Water Large Scale Plans & Details	BULLETIN 1	10/22/14
P4.1	Plumbing Riser Diagrams & Details	BULLETIN 1	10/22/14
M1.1	Mechanical General Information & Schedules	BULLETIN 1	10/22/14
M2.1	Mechanical Plan	BULLETIN 1	10/22/14
M3.1	Mechanical Large Scale Plans & Details	BULLETIN 1	10/22/14
M3.2	Mechanical Details	BULLETIN 1	10/22/14
F1.1	Fire Suppression General Information & Schedules	BULLETIN 1	10/22/14
E1.1	Electrical General Information & Schedules	BULLETIN 1	10/22/14
E1.2	Panel Schedules	BULLETIN 1	10/22/14
E1.3	Electrical Single Line Diagram and Details	BULLETIN 1	10/22/14
E2.1	Electrical Lighting Plan	BULLETIN 1	10/22/14
E2.1A	Electrical Lighting Dimensional Plan	BULLETIN 1	10/22/14
E2.2	Electrical Power Plan	BULLETIN 1	10/22/14
E2.3	Sound and Communication System	BULLETIN 1	10/22/14
E2.4	Security System Plan	BULLETIN 1	10/22/14
E2.5	Energy Management System Plan	BULLETIN 1	10/22/14
E3.1	Electrical Large Scale Plans, Details	BULLETIN 1	10/22/14
E3.2	Electrical Large Scale Plans, Details	BULLETIN 1	10/22/14
EMS1.1	Energy Management System Information & Details	BULLETIN 1	10/22/14

VERSION 2014 SWIS PROTOTYPE
 ARCH TRACKING SPREADSHEET #A387 - 09/10/14
 MEP TRACKING SPREADSHEET #E194 - 09/10/14

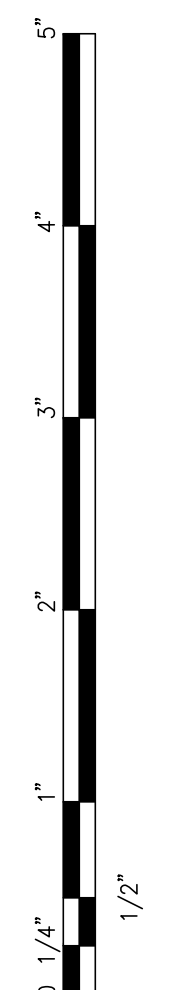

SBLM Architects #A0009343
 11430 N. Kendall Drive, Suite 310
 Miami, FL 33176
 Telephone 305-412-9187
 Fax: 305-412-6731
 www.sblm.com

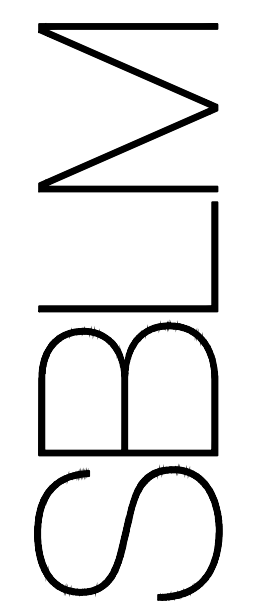

James Cohen
 Lic. #22580

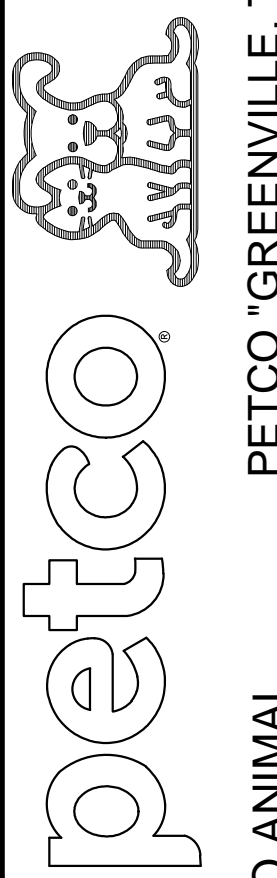

PETCO "GREENVILLE, TX"
 6834 WESLEY STREET
 GREENVILLE, TX

DISTRIBUTION:	DATE:
75% SUBMISSION	08-11-11
98% SUBMISSION	08-16-11
100% SUBMISSION	09-23-11
PERMIT SET	09-28-11
FINAL PERMIT SET	09-20-13
BULLETIN 1	10-22-14

DRAWING TITLE:
 CODE DATA
 PROJECT DATA
 A0.1