

KARI LANE
(VARIABLE WIDTH R.O.W.)

WESLEY STREET
(VARIABLE WIDTH R.O.W.)

GRADING LEGEND

FF 554.70	FINISHED FLOOR ELEVATION
TC 50.00	TOP OF CURB
TP 50.00	TOP OF PAVEMENT
TW 50.00	TOP OF SIDEWALK
M.E.P.	MATCH EXISTING PAVEMENT
M.E.C.	MATCH EXISTING CURB
---	PROPOSED SAWCUT LINE
- - -	PROPOSED CONTOUR
- - -	PROPOSED DRAINAGE FLOW

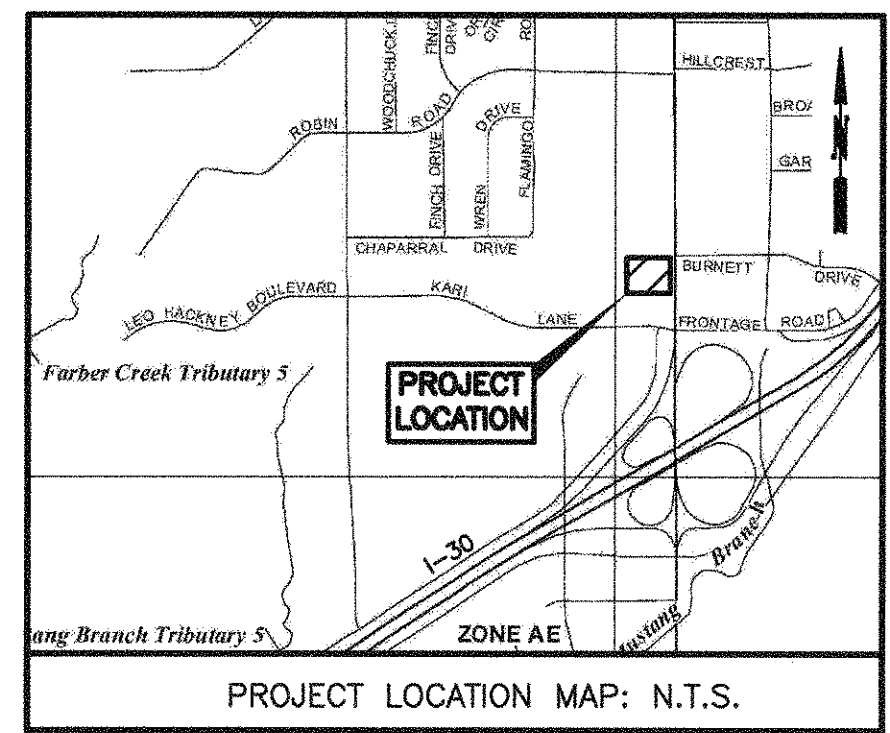
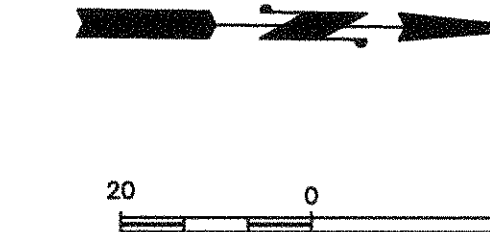

APPENDIX NO. 1 03/18/15

FLOODPLAIN INFORMATION:
THIS TRACT LIES IN ZONE "X" (UNSHADED), DEFINED AS AREAS DETERMINED TO BE OUTSIDE THE 0.2% ANNUAL CHANCE FLOODPLAIN (OUTSIDE THE 100-YEAR AND THE 500-YEAR FLOODPLAIN) ACCORDING TO THE NATIONAL FLOOD INSURANCE PROGRAM FIRM, MAP NUMBER 482302380G, COMMUNITY PANEL NUMBER 485473 0300G, LATEST AVAILABLE PUBLISHED REVISION, DATED JANUARY 6, 2012.

BENCHMARK NOTE:
ELEVATIONS SHOWN HEREON ARE BASED ON SITE BENCHMARK "X" CUT ON CONCRETE CURB OF PARKING ISLAND LOCATED IN THE CENTER OF PARKING LOT OF SHOPPING MALL APPROX. 12' N.E. OF FLAG POLE (DENOTED AS TBM #) ON TOP BY COTTON SURVEYING COMPANY DATED MAY 2009).

SITE BENCHMARK:
ELEV. = 556.80'

PROJECT BENCHMARK:
BOX CUT ON TOP OF CURB.
ELEV. = 554.93'

LEGAL DESCRIPTION:
A PORTION OF CROSSROADS GREENVILLE PROPERTIES, LTD. (CALLED 0.858 ACRES) VOL. 652, PG. 552 D.R.H.C.T.

PROPERTY ADDRESS:
6908 WESLEY STREET
GREENVILLE, TEXAS 75401

WINDLE + VOLPE
ARCHITECTS
7600 SHIFFRIDE
HOUSTON, TEXAS 77063
PH: 713-925-1590

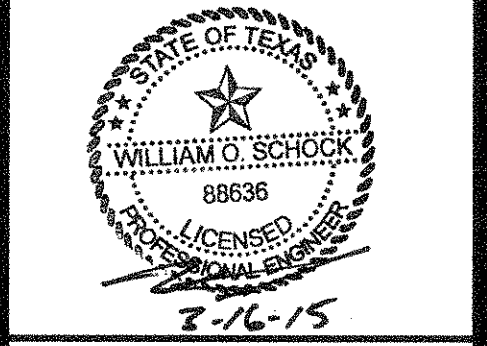

PAD BUILDING AT THE
CROSSROADS MALL
GREENVILLE, TEXAS
GREENVILLE PROPERTIES LTD.
GREENVILLE, TEXAS

DATE	3/16/15	JCM
PROJECT NO.	08-14-05	JCM
DRAWN BY		JCM

SITE
GRADING
PLAN
C6

TERRA
ASSOCIATES, INC.
CONSULTING ENGINEERS
404 E. RAMSEY RD., STE. 104
SAN ANTONIO, TEXAS 78216
PHONE: 210-288-1600
EMAIL: BOS@terraassoc.com
TBPE Registration No.: F-003832