

| CCTV WIRING SCHEDULE | |
|----------------------|---|
| NO. | LOCATION |
| 1 | SALES FLOOR DOME CAMERA |
| 2 | SALES FLOOR DOME CAMERA |
| 3 | SALES FLOOR DOME CAMERA |
| 4 | SALES FLOOR DOME CAMERA |
| 5 | SALES FLOOR DOME CAMERA |
| 6 | FIXED CAMERA AT CASH OFFICE |
| 7 | COVERT CABLE DROP AT CASH OFFICE |
| 8 | COVERT CABLE DROP AT FRONT-LINE |
| 9 | COVERT CABLE DROP AT FRONT-LINE |
| 10 | FIXED CAMERA AT RECEIVING |
| 11 | COVERT CABLE DROP AT RECEIVING |
| 12 | COVERT CABLE DROP AT LOUNGE |
| 13 | FIXED CAMERA AT FITTING ROOM ENTRANCE |
| 14 | FIXED CAMERA AT SERVICE DESK |
| 15 | NOT USED |
| 16 | FIXED CAMERA AT CASH OFFICE ENTRANCE |
| 17 | FIXED CAMERA AT EGRESS HALL |
| 18 | COVERT CABLE DROP AT EGRESS HALL |
| 19 | COVERT CABLE DROP AT REGISTERS |
| 20 | COVERT CABLE DROP AT REGISTERS |
| 21 | COVERT CABLE DROP AT REGISTERS |
| 22 | COVERT CABLE DROP AT REGISTERS |
| 23 | COVERT CABLE DROP AT REGISTERS |
| 24 | COVERT CABLE DROP AT REGISTERS |
| 25 | FIXED CAMERA AT ELECTRIC ROOM OR SYSTEMS ROOM |

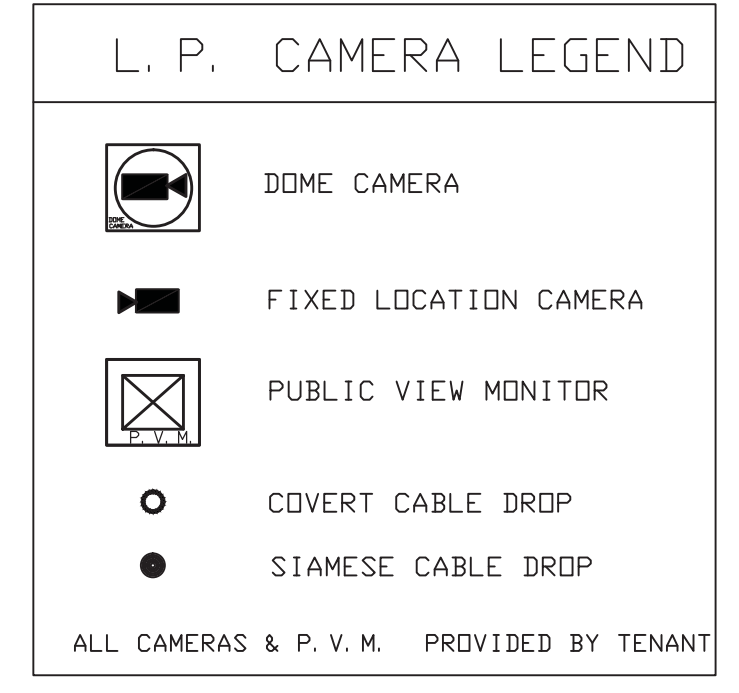

FIRE ALARM, SMOKE DETECTION & SECURITY SYSTEM NOTES

- It shall be the responsibility of the Electrical Contractor to provide all conduit systems, standard electrical boxes, and operating power for the fire alarm and security systems.
- Fire alarm and security systems installer to provide a separate drawings showing all devices. Coordinate and confirm with architect, electrical contractor, general contractor and/or owner prior to submit bidding.

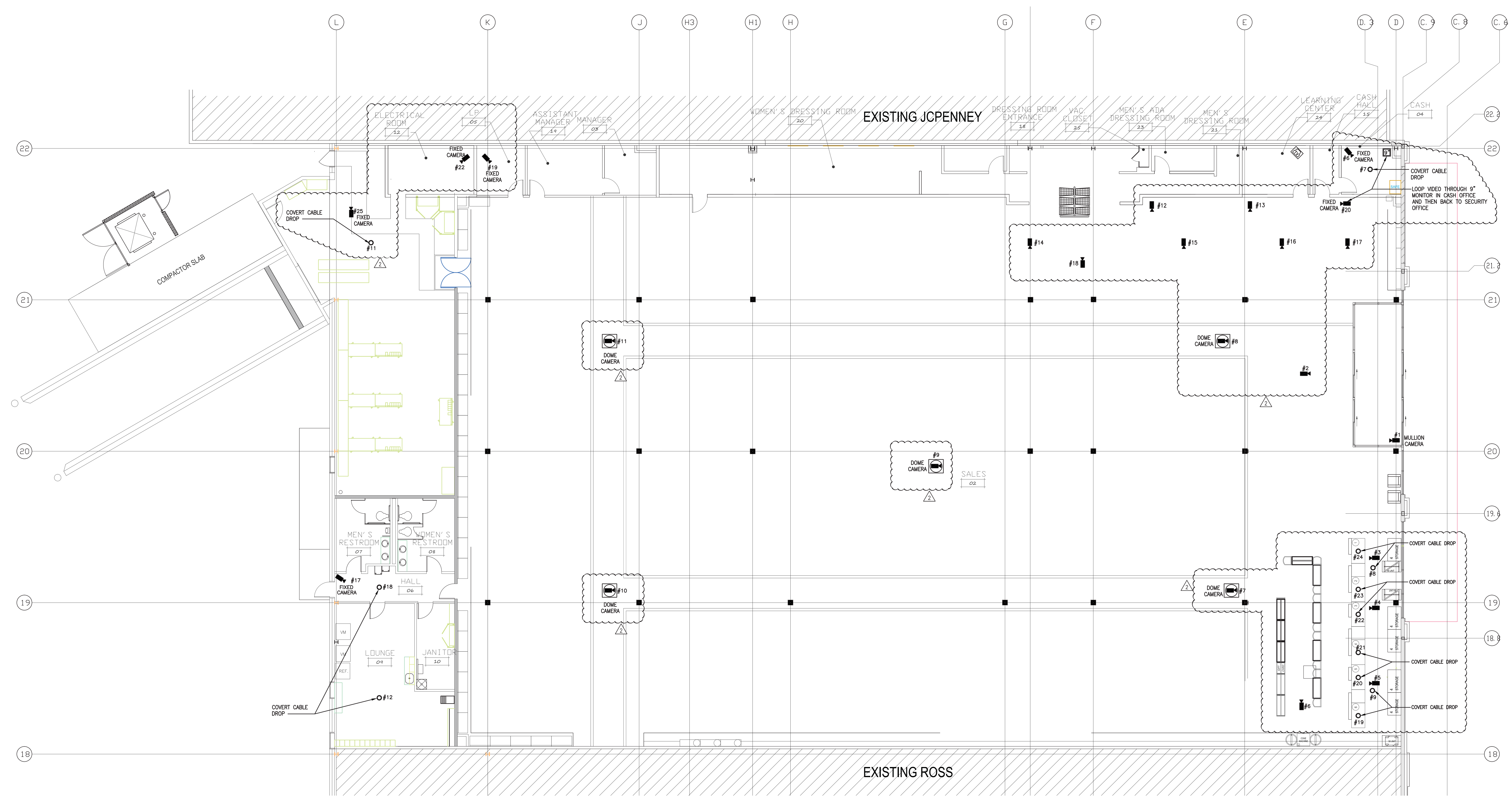

1 SECURITY CAMERAS FLOOR PLAN
E1.3 SCALE: 1/8" = 1'-0"