

FLOOR PLAN NOTES

- DO NOT SCALE THESE DRAWINGS FOR DIMENSIONAL INFORMATION. REFER TO DIMENSIONS ON THE FLOOR PLAN AND THE ENLARGED PLANS, IF THERE IS A CONFLICT WITH THE PLAN DIMENSIONS OR AN EXISTING FIELD CONDITION, CONTACT THE ARCHITECT.
- PROVIDE 5/8" THICK GYPSUM BOARD THROUGHOUT THE PROJECT, UNLESS NOTED OTHERWISE (TYPE 'X' IF REQUIRED).
- SEE PLUMBING DRAWINGS FOR ADDITIONAL INFORMATION ON FLOOR DRAINS, FLOOR SINKS, CLEANOUTS, ETC.
- ALL DRY-WALL PARTITION AND EXTERIOR WALL DIMENSIONS ARE TO FACE OF STUDS, STRIPPING, EITHER FACE OF EXTERIOR WALL OR CENTERLINE OF COLUMN, AS INDICATED.
- SEAL WALLS EXTENDING TO DECK, EACH SIDE.
- MECHANICAL AND ELECTRICAL APPARATUS PENETRATING WALLS IN EXPOSED AREAS SHALL BE SEALED AIR TIGHT.
- MAXIMUM CLEAR SPAN HEIGHTS FOR INTERIOR METAL STUDS SHALL BE SUCH THAT DEFLECTION UNDER A 5 PSF LATERAL LOAD SHALL NOT EXCEED 1/360 LOAD AT CERAMIC TILE FINISHES AND 1/200 AT ALL OTHER AREAS.
- THE GRAB BARS AT ACCESSIBLE TOILETS SHALL CONFORM TO THE STATE PURCHASING AND GENERAL SERVICES COMMISSION REQUIREMENTS.
- USE WATER-RESISTANT GYPSUM BOARD AT ALL WALLS TO RECEIVE CERAMIC TILE FINISH.
- WOOD FRAMING, BLOCKING, SHEATHING OR BRACING SHALL BE FIRE RETARDANT TREATED (UNLESS NOTED OTHERWISE).
- LANDLORD GENERAL CONTRACTOR TO PROVIDE HANDICAPPED ACCESSIBLE IDENTIFICATION/TAG TILE SIGNAGE AT ALL EXITS, HANDICAPPED FITTING ROOMS, AND RESTROOMS IN COMPLIANCE WITH IBC 1071.3 AND ICC ANSI A117.1.

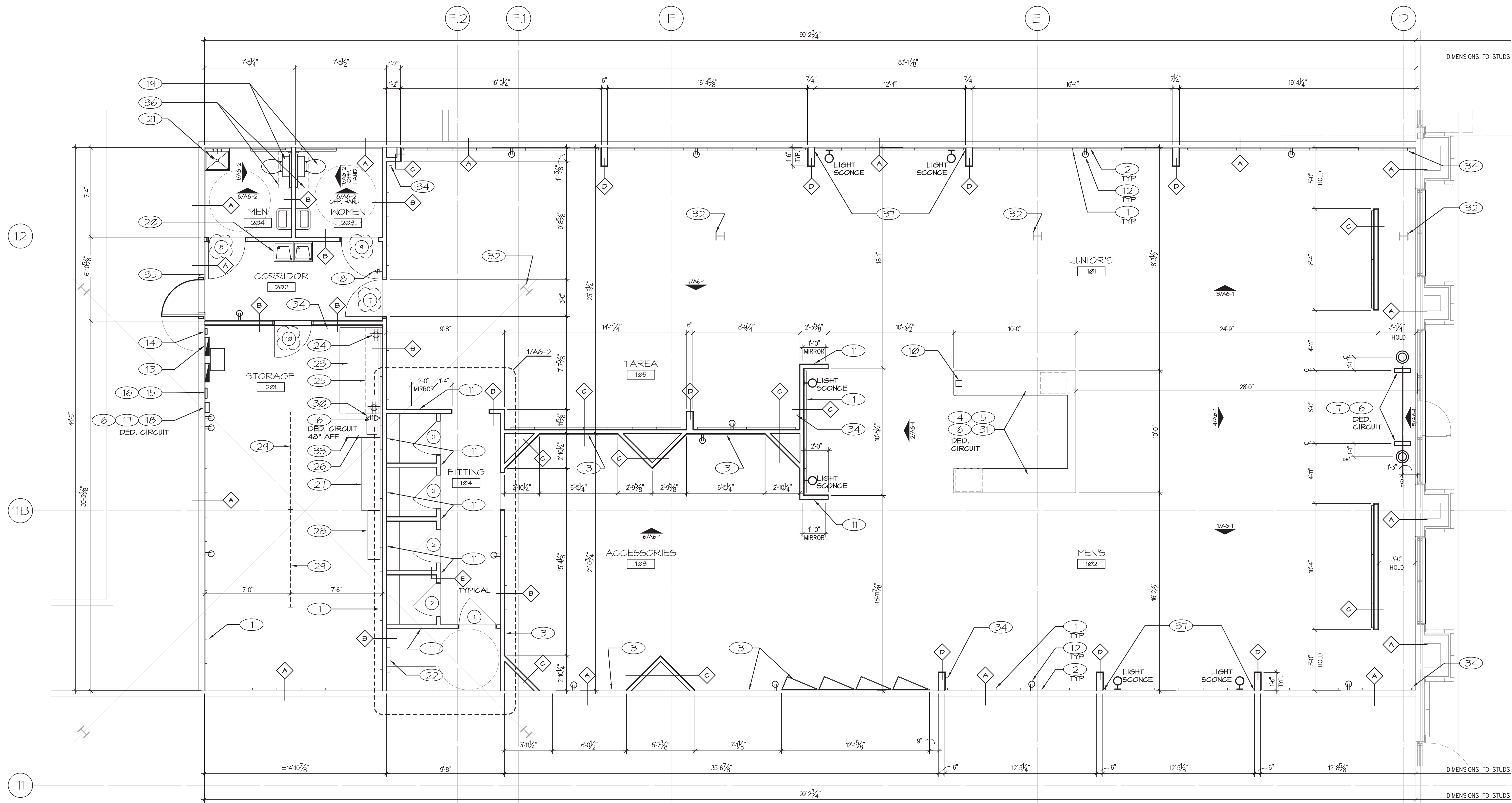

1 FLOOR PLAN
 A2-1 SCALE: 1/8" = 1'-0"

KEY NOTES #		EXISTING	N/A	CURRENT SCOPE	TENANT'S VENDOR	NOTES
TAG	DESCRIPTION			PROVIDE	INSTALL	
1	WALL MOUNTED STANDARDS					SEE MOUNTING SCHED. REFER TO TOGGLE DETAIL 1/A1-2. FASTENERS BY GC
2	PAINT WALLS P11 ABOVE TRIM ON SALES FLOOR ONLY UNLESS OTHERWISE NOTED, INSTALL BASE BI UNLESS OTHERWISE NOTED					REFER TO INTERIOR ELEVATIONS ON A6-1 AND A6-2
3	SLATHALL SAWTOOTH AND DISPLAY PANELS					
4	CASH WRAP					
5	POKER/TELECOM FOR NEW CASH DESK FROM ABOVE VIA MILLWORK RACKWAY					
6	PROVIDE POKER ON DEDICATED CIRCUITS, PROVIDE ORANGE RECEPTACLES					LABEL BREAKERS AT PANEL, INSTALL BREAKER LOCKS
7	TENANT'S SENSORMATIC SYSTEM-FULLY DEDICATED CIRCUIT, NO SHARED NEUTRAL, LINE OR GROUND					PROVIDE A RECEPTACLE ABOVE THE CEILING FOR POWER
8	SWITCH BANK LOCATION-SWITCHES FOR ALL SALES FLOOR LIGHTING CIRCUITS					REFER TO ELECTRICAL DRAWINGS
9	STOREFRONT SYSTEM					
10	PROVIDE NEW HONEYWELL TB8220U COMMERCIAL PROGRAMMABLE TSTAT, INSTALL ON MILLWORK RACKWAY					COMPATIBLE WITH HVAC EQUIPMENT, COORDINATE PROGRAM W/MANAGER
11	MIRROR 60" TALL MIRROR AT 12" AFF, TYPICAL					APPLY DAP CLEAR CAULK AT ALL EXPOSED EDGES
12	ELECTRICAL RECEPTACLES (20% +/- O.C. IN SALES AREA) AS SHOWN, LIGHT ALMOND COVERS/PLUGS					LANDLORD GC TO INSTALL RECEPTACLES AS SHOWN AT WALLS IN THEIR SCOPE
13	ELECTRICAL EQUIPMENT					REFER TO ELECTRICAL DRAWINGS
14	SIGN TIME SWITCH (PARAGON 1000 SERIES OR APPROVED EQUAL)					SET TIMER PRIOR TO TURNOVER- COORDINATE TIMES WITH TENANT
15	TELEPHONE PUNCH BOARD LOCATION					TELEPHONE COMPANY TO INSTALL LINES TO THIS LOCATION
16	RUN INTERIOR LINES TO BOARD, USE PLENUM RATED WIRE WHERE REQUIRED					GC TO PROVIDE 4"x4" FIRE RETARDANT TREATED PLYWOOD BD.
17	TENANT'S BURGLAR ALARM SYSTEM PANEL					

KEY NOTES #		EXISTING	N/A	CURRENT SCOPE	TENANT'S VENDOR	NOTES
TAG	DESCRIPTION			PROVIDE	INSTALL	
18	PROVIDE (1) DUPLEX RECEPTACLE MOUNTED AT 48" AFF					
19	RESTROOM(S)					COMPLY WITH ALL APPLICABLE ACCESSIBILITY CODES. SEE DETAILS ON A6-2
20	HI-LO DRINKING FOUNTAIN					COMPLY WITH ALL APPLICABLE ACCESSIBILITY CODES
21	MOP SINK-FIAT #FL-1 LAUNDRY TUB STYLE WITH LEGS					COMPLY WITH ALL APPLICABLE ACCESSIBILITY CODES
22	WALL MOUNTED GRAB BARS- GC TO INSTALL BLOCKING IN WALL AS NEEDED					COMPLY WITH ALL APPLICABLE ACCESSIBILITY CODES
23	6'-0"x30"x3'-0"H FOLDING TABLE					
24	PROVIDE (1) QUAD RECEPTACLE, COORDINATE LOCATION WITH TENANT					MOUNT AT 48" AFF
25	12" DEEP ADJUSTABLE SHELVES ABOVE TABLE					
26	IN-STORE MUSIC SYSTEM, INSTALL IN DATA CABINET.					3/4" CONDUIT IN WALL FROM WALL JB TO STRUCT. AND TURN TO SALES AREA WITH PULL STRINGS
27	EQUIPMENT RACK					
28	POSTER HOLDER					
29	1 1/4" ROUND (RIGID PIPE) x 8' LONG HANGING ROD					SUSPEND FROM ABOVE USING ALL- THREAD MOUNTED AT 18"-0" AFF, SEE AT-2
30	SAFE					BOLT DOWN TO FLOOR, INSTALL UNDER DATA CABINET
31	BASE TRIM BI AT BASE OF CASH WRAP					
32	CLEAN/SAND COLUMN(S) SMOOTH, PAINT P11 (EUROPEAN WHITE)					
33	DATA CABINET- PROVIDE POWER TO LOCATION @ 48" AFF, SEE SHEET AT-2					2" CONDUIT IN WALL FROM WALL JB TO STRUCTURE AND TURN TO SALES AREA
34	RETRIEVER HOOKS-MOUNT AT 84" AFF, SEE DETAIL ON 5/A1-2					MOUNTINGS WITH TOGGLES, REFER TO TOGGLE DETAIL 1/F4

KEY NOTES #		EXISTING	N/A	CURRENT SCOPE	TENANT'S VENDOR	NOTES
TAG	DESCRIPTION			PROVIDE	INSTALL	
35	DOOR BUZZER					RING ON SALES FLOOR (ABOVE C/W) AND STOCK ROOM (ABOVE DESK)
36	RESTROOM SHELVING					
37	SALES FLOOR FEATURE WALL					WHERE A PILASTER/PROTRUSION EXISTING IN FEATURE WALL AREAS, FURR CUT WALL AREA BETWEEN DIVIDER WALLS FLUSH WITH PILASTER TO 11'-4"

WALL STANDARD MOUNTING SCHEDULE:

CEILING HEIGHT	STANDARD HEIGHT	REMARKS
LESS THAN 9'-4" AFF	TOP OF STANDARD AT CEILING HEIGHT	CUT DOWN AS NEEDED
9'-4" TO 11'-0" AFF	TOP OF STANDARD AT CEILING HEIGHT	9'-4" LONG STANDARDS
11'-6" AFF AND HIGHER	TOP OF STANDARD AT 11'-0" AFF	INSTALL TRIM AT 11'-0" AFF*

HALL STANDARDS TO BE INSTALLED AT 2'-0" O.C. UNO. - SEE INTERIOR ELEVATIONS FOR ADDITIONAL CLARIFICATION
 * TRIM PROVIDED BY TENANT'S VENDOR, INSTALLED BY GC, SEE SHEET A4 FOR LOCATIONS AND FINISHES

Hermes Architects
 Members A.I.A.
 1177 West Loop South, Ste. 500
 Houston, Texas 77027
 Tel. 713-765-3644
 www.hermesarchitects.com
 Houston • Dallas • Ft. Worth

This document is an instrument of service protected by the copyright law of the United States of America, 17 U.S.C. § 102, and shall not be copied or reproduced without the express written consent of Hermes Architects, Inc.

INCOMPLETE DRAWING - DO NOT USE FOR REGULATORY APPROVAL, PERMIT OR CONSTRUCTION
 ARCHITECT: Roger R. Wrede
 REGISTRATION #: 17468
 DATE: 09/23/2011

CROSSROADS MALL
 RUE 21
 6834 WESLEY STREET
 GREENVILLE, TEXAS 75401

Crossroads
 GREENVILLE PROPERTIES LTD.

10850 WILCHIRE BLVD.
 SUITE 1050
 LOS ANGELES, CA 90024

DATE: SEPTEMBER 4, 2011
 PROJECT NO.: 809501
 DRAWN BY: --
 CHECKED BY: --

FLOOR PLAN

RUE-A2-1

K:\809500\DRAWINGS\4-PLOT SHEETS\SHEETS\RUE-A2-1 FLOOR PLAN.DWG 9/16/2011 7:57:27 AM AMY FELTON