

NOTES:

1. CONCRETE SHALL HAVE A 28 DAY COMPRESSIVE STRENGTH OF 3000 PSI WITH A MAXIMUM AGGREGATE SIZE OF 3/4" AND A MAXIMUM WATER / CEMENT RATIO OF 0.54.
2. ALL REINFORCEMENT SHALL CONFORM TO ASTM A615, GR. 60.
3. ASSUMPTIONS FOR FOUNDATION DESIGN INCLUDE A 10", 40 FT. POLE W/ FIXTURES AND A MAXIMUM EQUIV. PROJECTED AREA OF 10.6 sq. ft.
4. SEE ELECTRICAL DRAWINGS AND SPECIFICATIONS FOR ADDITIONAL INFORMATION AND REQUIREMENTS.

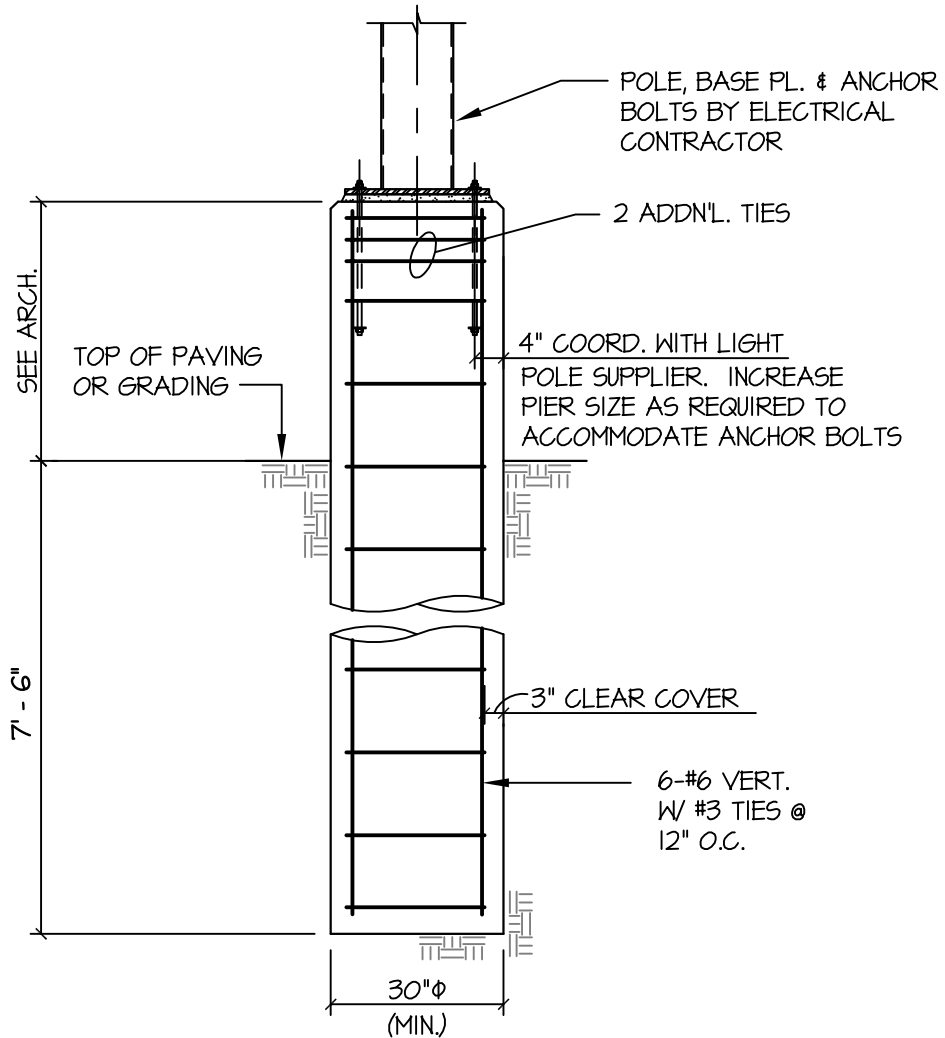

**TYPICAL DETAIL
LIGHT POLE FOUNDATION**

Matrix Structural Engineers
TBPE Firm Registration No. F-2640

MATRIX
STRUCTURAL
ENGINEERS
MSE11045

24 GREENWAY PLAZA
SUITE 1508
HOUSTON, TEXAS 77046-2401
PHONE: (713) 664-0130
FAX: (713) 664-1370

REF: .

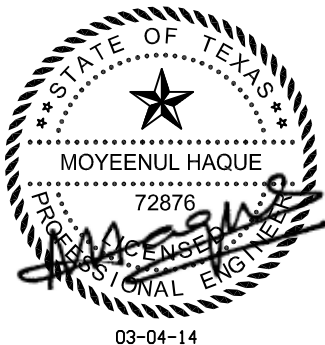

ARCHITECT: WINDLE + VOLPE ARCHITECTS		JOB NUMBER:
PROJECT: CROSSROADS MALL RENOVATION		
Date: 03-04-14	Revision:	Drawing No.
Drawn by: BN		S-SK-01
Check by: AM		