

**SECTION 16010 - GENERAL PROVISIONS**

- WORK CONSISTS OF FURNISHING LABOR, MATERIALS, EQUIPMENT AND SERVICES REQUIRED FOR THE COMPLETE INSTALLATION OF ELECTRICAL WORK SHOWN IN THE CONTRACT DOCUMENTS AND SPECIFIED IN DIVISION 16.
- INCLUDE ALL PARTS AND LABOR, WHICH ARE INCIDENTAL AND NECESSARY FOR A COMPLETE AND OPERABLE INSTALLATION EVEN THOUGH NOT SPECIFICALLY MENTIONED IN THE CONTRACT DOCUMENTS. SUCH ITEMS INCLUDE NUTS, BOLTS, ANCHORS, BRACKETS, SLEEVES, OFFSETS IN CONDUIT, FITTINGS, RELAYS, ETC.
- PROVIDE TEMPORARY AND PERMANENT UTILITY SERVICES AS REQUIRED AND COORDINATE THEIR INSTALLATION WITH CONSTRUCTION PROGRESS OF THIS PROJECT. PAY ALL FEES AND COSTS CHARGED BY UTILITY COMPANIES FOR UTILITY SERVICES.
- OBTAIN ALL TEMPORARY AND PERMANENT PERMITS AND LICENSES REQUIRED IN CONNECTION WITH THIS DIVISION'S WORK. PAY ALL FEES AND EXPENSES REQUIRED FOR SUCH PERMITS AND LICENSES.
- REQUEST INSPECTIONS AS REQUIRED BY REGULATING AGENCIES AND/OR REGULATIONS. PAY ALL CHARGES FOR INSPECTIONS BY REGULATING AGENCIES OF INSTALLATIONS OF PLANS AND SPECIFICATIONS.
- INCLUDE STATE AND LOCAL SALES TAXES IN THE BID. KEEP ACCURATE RECORDS OF THESE TAXES AND FURNISH SUCH RECORDS TO THE TENANT UPON REQUEST.
- MEET OR EXCEED ALL CURRENT APPLICABLE CODES, ORDINANCES AND REGULATIONS FOR ALL INSTALLATIONS. PROMPTLY NOTIFY THE ENGINEER, IN WRITING, IF THE CONTRACT DOCUMENTS APPEAR TO CONFLICT WITH GOVERNING CODES AND REGULATIONS. CONTRACTOR ASSUMES ALL RESPONSIBILITY AND COSTS FOR CORRECTING NON-COMPLYING WORK INSTALLED WITHOUT NOTIFYING THE ENGINEER.
- HIGHER QUALITY OF WORKMANSHIP AND MATERIALS INDICATED IN THE CONTRACT DOCUMENTS TAKES PRECEDENCE OVER THAT ALLOWED IN REFERENCED CODES AND STANDARDS.
- THE TERMS DEFINED BELOW APPLY TO ALL WORK INCLUDED IN DIVISION 16.

- THE TERM "WORK" MEANS THE CONSTRUCTION AND SERVICES REQUIRED BY THE CONTRACT DOCUMENTS AND INCLUDES ALL OTHER LABOR, MATERIALS, EQUIPMENT AND SERVICES PROVIDED OR TO BE PROVIDED BY THE CONTRACTOR TO FULFILL THE CONTRACTOR'S OBLIGATIONS.
- FURNISH - TO OBTAIN IN NEW CONDITION READY FOR INSTALLATION INTO THE WORK.
- INSTALL - TO STORE, SET IN PLACE, CONNECT AND PLACE INTO OPERATION INTO THE WORK.
- PROVIDE - TO FURNISH AND INSTALL.
- CONNECT - TO BRING SERVICE TO THE EQUIPMENT AND MAKE FINAL ATTACHMENT INCLUDING NECESSARY SWITCHES, OUTLETS, BOXES, TERMINATIONS, ETC.
- CONDUIT INCLUDES IN ADDITION TO CONDUIT, ALL FITTINGS, PULL BOXES, HANGERS AND OTHER SUPPORTS AND ACCESSORIES RELATED TO SUCH CONDUIT.
- CONCEALED - HIDDEN FROM SIGHT IN CHASES, FURRED SPACES, SHAFTS, HUNG CEILINGS, EMBEDDED IN CONSTRUCTION, IN CRAWL SPACES OR BURIED.
- EXPOSED: NOT INSTALLED UNDERGROUND NOR CONCEALED AS DEFINED ABOVE.
- THE DRAWING AND SPECIFICATIONS CONSTITUTE THE CONTRACT DOCUMENTS. ANY ITEM NOTED IN THE SPECIFICATION OR SHOWN ON THE DRAWINGS IS INCLUDED IN THE CONTRACT DOCUMENTS.
- ALL ELECTRICAL DETAILS AND DRAWINGS ARE DIAGRAMMATIC, UNLESS SPECIFICALLY NOTED. FIELD VERIFY ALL DIMENSIONS AND NOTIFY THE ENGINEER OF ANY CONFLICTS OR DISCREPANCIES, IN WRITING, PRIOR TO INSTALLATION.
- INITIATE, MAINTAIN AND SUPERVISE ALL SAFETY PRECAUTIONS REQUIRED WITH THIS WORK IN ACCORDANCE WITH THE REGULATIONS OF THE OCCUPATIONAL SAFETY AND HEALTH ADMINISTRATION (OSHA) AND OTHER GOVERNING AGENCIES.
- BEFORE SUBMITTING A PROPOSAL ON THE WORK CONTEMPLATED, EXAMINE THE SITE OF THE PROPOSED WORK AND BECOME THOROUGHLY FAMILIAR WITH EXISTING CONDITIONS AND LIMITATIONS. NO EXTRA COMPENSATION WILL BE ALLOWED BECAUSE OF MISUNDERSTANDING AS TO THE AMOUNT OF WORK INVOLVED NOR BIDDERS LACK OF KNOWLEDGE OF EXISTING CONDITIONS WHICH COULD HAVE BEEN DISCOVERED OR REASONABLY ANTICIPATED PRIOR TO BIDDING.
- INSTALL ALL CONDUIT, EQUIPMENT, ETC. ALLOWING PROPER CODE AND MAINTENANCE CLEARANCES AND TO AVOID BLOCKING PASSAGEWAYS AND ACCESS PANELS.
- WHERE WORK MUST BE REPLACED DUE TO THE FAILURE OF THE CONTRACTOR TO VERIFY THE CONDITIONS EXISTING ON THE JOB, SUCH REPLACEMENT MUST BE ACCOMPLISHED AT NO COST TO THE TENANT. THIS APPLIES TO SHOP FABRICATED WORK AS WELL AS TO WORK FABRICATED IN PLACE.
- THROUGHOUT THE COURSE OF THE WORK, MINOR CHANGES AND ADJUSTMENTS TO THE INSTALLATION MAY BE REQUESTED BY THE ENGINEER. THE CONTRACTOR SHALL MAKE ADJUSTMENTS WITHOUT ADDITIONAL COST TO THE TENANT, WHERE SUCH ADJUSTMENTS ARE NECESSARY TO THE PROPER INSTALLATION AND OPERATION WITHIN THE INTENT OF THE CONTRACT DOCUMENTS. THIS DOES NOT INCLUDE WORK ALREADY COMPLETED.
- DRAWINGS AND SPECIFICATIONS ARE COMPLEMENTARY AND WHAT IS CALLED FOR IN EITHER ONE IS AS BINDING AS IF CALLED FOR IN BOTH.
- INCLUDE THE BETTER QUALITY, GREATER QUANTITY OR HIGHER COST FOR AN ITEM OR ARRANGEMENT WHERE A DISAGREEMENT EXISTS IN THE DRAWINGS AND SPECIFICATIONS.
- GUARANTEE AND MAINTAIN THE STABILITY OF WORK AND MATERIALS AND KEEP SAME IN PERFECT REPAIR AND CONDITION FOR THE PERIOD OF ONE (1) YEAR AFTER THE FINAL COMPLETION OF THE WORK.
- DEFECTS OF ANY KIND DUE TO FAULTY WORK OR MATERIALS APPEARING DURING THE ABOVE MENTIONED PERIOD MUST BE IMMEDIATELY MADE GOOD BY THE CONTRACTOR AT HIS OWN EXPENSE TO THE ENTIRE SATISFACTION OF THE TENANT AND ARCHITECT AND ENGINEER. INCLUDE DAMAGE TO THE FINISH OR THE BUILDING RESULTING FROM THE ORIGINAL DEFECT OR REPAIRS.
- REPLACE POLES FIXTURES, ELECTRIC EQUIPMENT, ETC., DAMAGED BY ANY CONTRACTOR DURING THE COURSE OF CONSTRUCTION.
- MATERIALS FURNISHED FOR THE TEMPORARY POWER SYSTEM REMAIN CONTRACTORS PROPERTY. REMOVE WHEN THERE IS NO LONGER ANY NEED FOR TEMPORARY POWER.
- DO NOT DISTURB NORMAL USE OF THE FACILITY, EXCEPT WITHIN THE IMMEDIATE CONSTRUCTION AREA. KEEP WALKS, DRIVEWAYS, ENTRANCES, ETC. FREE AND CLEAR OF EQUIPMENT, MATERIAL AND DEBRIS.
- STORE ALL EQUIPMENT AND MATERIAL IN A PLACE AND MANNER THAT MINIMIZES CONGESTION AND IS APPROVED BY THE TENANT.
- PROVIDE NEW MATERIAL AND EQUIPMENT, UNLESS NOTED OTHERWISE. PROTECT EQUIPMENT AND MATERIAL FROM DAMAGE, DIRT AND THE WEATHER.
- PROVIDE THE HIGHEST QUALITY WORKMANSHIP AND PERFORM ALL WORK ONLY BY SKILLED MECHANICS. INSTALL MATERIAL AND EQUIPMENT IN ACCORDANCE WITH MANUFACTURERS' RECOMMENDATIONS, INSTRUCTIONS AND CURRENT NECA STANDARDS.
- THE OWNER RESERVES THE RIGHT TO REJECT MATERIAL OR WORKMANSHIP NOT IN ACCORDANCE WITH THE SPECIFICATIONS, BEFORE OR AFTER INSTALLATION.
- PERFORM ALL CUTTING AND PATCHING NECESSARY TO WORK, UNLESS SPECIFICALLY DELEGATED TO THE GENERAL CONTRACTOR. OBTAIN SPECIAL PERMISSION FROM THE LANDLORD BEFORE CUTTING STRUCTURAL MEMBERS OR FINISHED MATERIAL. PERFORM ALL PATCHING IN SUCH A MANNER AS TO LEAVE NO VISIBLE TRACE AND RETURN THE AREA AFFECTED TO THE CONDITION OF UNDISTURBED WORK. PERFORM ALL PATCHING BY WORKERS EXPERIENCED, SKILLED, AND LICENSED FOR THE PARTICULAR TYPE OF WORK INVOLVED. INFERIOR WORK WILL NOT BE ACCEPTED.
- ALL CONCRETE TO BE REMOVED SHALL BE PATCHED TO MATCH EXISTING CONCRETE. WORK TO BE PERFORMED BY CONCRETE CONTRACTOR.
- REFINISH ALL ELECTRICAL EQUIPMENT DAMAGED DURING SHIPPING AND/OR INSTALLATION TO ITS ORIGINAL CONDITION. REMOVE ALL RUST, PRIME, AND PAINT PER MANUFACTURER'S RECOMMENDATIONS FOR FINISH EQUAL TO ORIGINAL.
- ALL NEW RACEWAY SYSTEMS ARE TO BE CONCEALED.
- AFTER TESTS HAVE BEEN MADE AND ACCEPTED, CLEAN PANELS AND OTHER EQUIPMENT INSTALLED BY THE CONTRACTOR, LEAVING THE ENTIRE WORK AREA IN A CLEAN AND COMPLETE WORKING ORDER.
- OPERATE EQUIPMENT AND SYSTEMS IN ALL THEIR OPERATING MODES, TO VERIFY PROPER OPERATION, PRIOR TO FINAL ACCEPTANCE AND OWNER INSTRUCTIONS. NOTIFY THE ENGINEER, IN WRITING, THAT ALL SYSTEMS HAVE BEEN TESTED AND ARE FUNCTIONING AND OPERATING PROPERLY.
- INCLUDE DOCUMENTATION OF INSTRUCTIONS IN THE OPERATION AND MAINTENANCE MANUALS.
- CONTRACTOR IS RESPONSIBLE FOR ANY DAMAGE TO ELECTRICAL EQUIPMENT OR MATERIALS UNTIL FINAL ACCEPTANCE OF THE ENTIRE PROJECT BY THE TENANT. KEEP ALL EQUIPMENT CLEAN MATERIALS UNTIL FINAL ACCEPTANCE OF THE ENTIRE PROJECT BY THE TENANT.

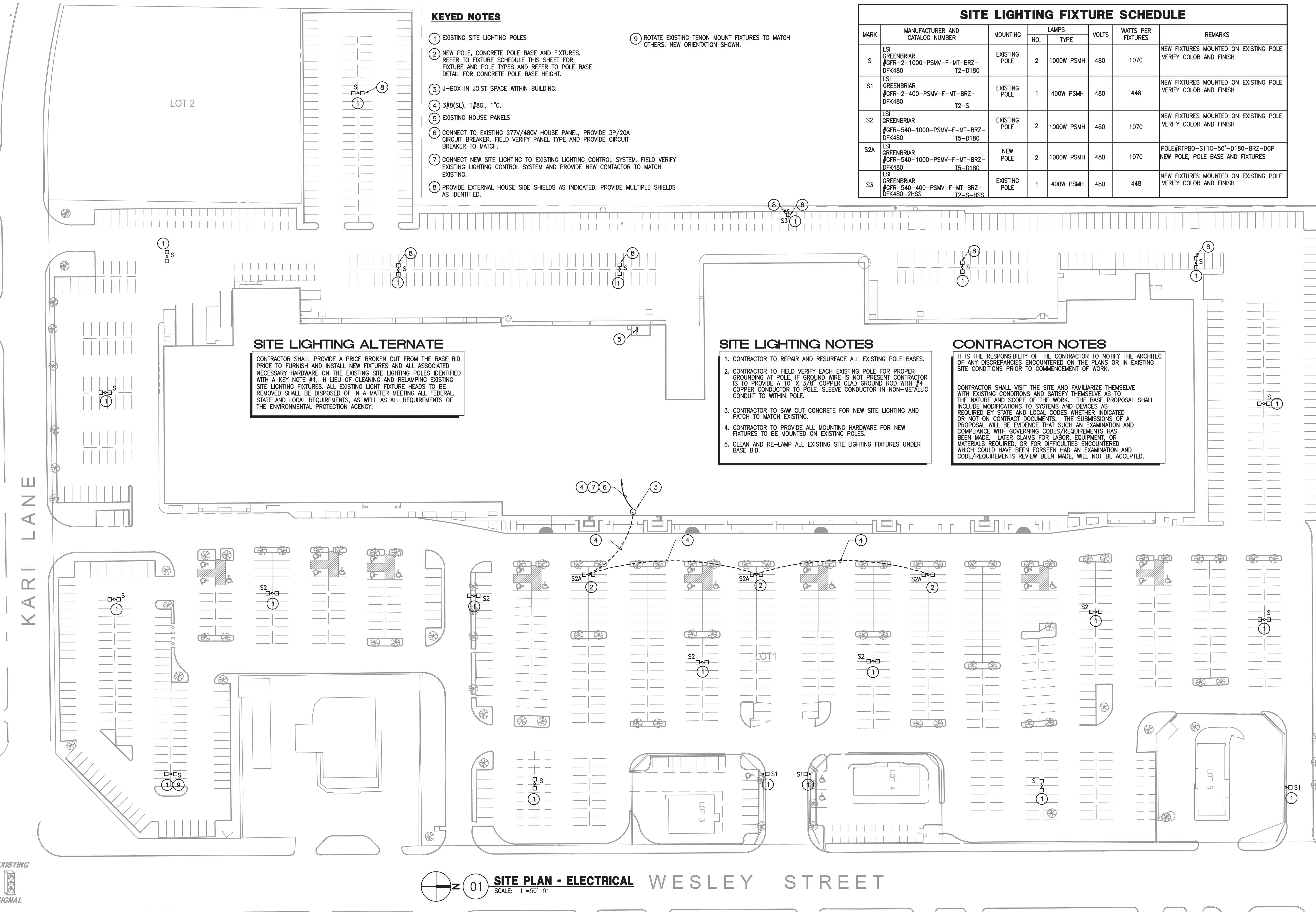

**KEYED NOTES**

- EXISTING SITE LIGHTING POLES
- NEW POLE, CONCRETE POLE BASE AND FIXTURES. REFER TO FIXTURE SCHEDULE THIS SHEET FOR FIXTURE AND POLE TYPES AND REFER TO POLE BASE DETAIL FOR CONCRETE POLE BASE HEIGHT.
- J-BOX IN JOIST SPACE WITHIN BUILDING.
- 3/8\"(SL), 1\"(RG), 1\"C.
- EXISTING HOUSE PANELS
- CONNECT TO EXISTING 277V/480V HOUSE PANEL. PROVIDE 3P/20A CIRCUIT BREAKER. FIELD VERIFY PANEL TYPE AND PROVIDE CIRCUIT BREAKER TO MATCH.
- CONNECT NEW SITE LIGHTING TO EXISTING LIGHTING CONTROL SYSTEM. FIELD VERIFY EXISTING LIGHTING CONTROL SYSTEM AND PROVIDE NEW CONTRACTOR TO MATCH EXISTING.
- PROVIDE EXTERNAL HOUSE SIDE SHIELDS AS INDICATED. PROVIDE MULTIPLE SHIELDS AS IDENTIFIED.
- ROTATE EXISTING TENON MOUNT FIXTURES TO MATCH OTHERS. NEW ORIENTATION SHOWN.

SITE LIGHTING FIXTURE SCHEDULE							
MARK	MANUFACTURER AND CATALOG NUMBER	MOUNTING	LAMPS		VOLTS	WATTS PER FIXTURES	REMARKS
			NO.	TYPE			
S	LSI GREENBRIAR #GFR-2-1000-PSMV-F-MT-BRZ-DK480	EXISTING POLE	2	1000W PSMH	480	1070	NEW FIXTURES MOUNTED ON EXISTING POLE VERIFY COLOR AND FINISH
S1	LSI GREENBRIAR #GFR-2-400-PSMV-F-MT-BRZ-DK480	EXISTING POLE	1	400W PSMH	480	448	NEW FIXTURES MOUNTED ON EXISTING POLE VERIFY COLOR AND FINISH
S2	LSI GREENBRIAR #GFR-540-1000-PSMV-F-MT-BRZ-DK480	EXISTING POLE	2	1000W PSMH	480	1070	NEW FIXTURES MOUNTED ON EXISTING POLE VERIFY COLOR AND FINISH
S2A	LSI GREENBRIAR #GFR-540-1000-PSMV-F-MT-BRZ-DK480	NEW POLE	2	1000W PSMH	480	1070	POLE #RTP90-S11G-S0-D180-BRZ-DGP NEW POLE, POLE BASE AND FIXTURES
S3	LSI GREENBRIAR #GFR-540-400-PSMV-F-MT-BRZ-DK480-2HSS	EXISTING POLE	1	400W PSMH	480	448	NEW FIXTURES MOUNTED ON EXISTING POLE VERIFY COLOR AND FINISH

**SITE LIGHTING ALTERNATE**

CONTRACTOR SHALL PROVIDE A PRICE BROKEN OUT FROM THE BASE BID PRICE TO FURNISH AND INSTALL NEW FIXTURES AND ALL ASSOCIATED NECESSARY HARDWARE ON THE EXISTING SITE LIGHTING POLES IDENTIFIED WITH A KEY NOTE #1, IN LIEU OF CLEANING AND RELAMPING EXISTING SITE LIGHTING FIXTURES. ALL EXISTING LIGHT FIXTURE HEADS TO BE REMOVED SHALL BE DISPOSED OF IN A MANNER MEETING ALL FEDERAL, STATE AND LOCAL REQUIREMENTS, AS WELL AS ALL REQUIREMENTS OF THE ENVIRONMENTAL PROTECTION AGENCY.

**SITE LIGHTING NOTES**

- CONTRACTOR TO REPAIR AND RESURFACE ALL EXISTING POLE BASES.
- CONTRACTOR TO FIELD VERIFY EACH EXISTING POLE FOR PROPER GROUNDING AT POLE. IF GROUND WIRE IS NOT PRESENT CONTRACTOR IS TO PROVIDE A 10\" x 3/8\" COPPER GLAD GROUND ROD WITH #4 COPPER CONDUCTOR TO POLE SLEEVE CONDUCTOR IN NON-METALLIC CONDUIT TO WITHIN POLE.
- CONTRACTOR TO SAW OUT CONCRETE FOR NEW SITE LIGHTING PATCH TO MATCH EXISTING.
- CONTRACTOR TO PROVIDE ALL MOUNTING HARDWARE FOR NEW FIXTURES TO BE MOUNTED ON EXISTING POLES.
- CLEAN AND RE-LAMP ALL EXISTING SITE LIGHTING FIXTURES UNDER BASE BID.

**CONTRACTOR NOTES**

IT IS THE RESPONSIBILITY OF THE CONTRACTOR TO NOTIFY THE ARCHITECT OF ANY DISCREPANCIES ENCOUNTERED ON THE PLANS OR IN EXISTING SITE CONDITIONS PRIOR TO COMMENCEMENT OF WORK.  
  
CONTRACTOR SHALL VISIT THE SITE AND FAMILIARIZE THEMSELVES WITH EXISTING CONDITIONS AND SATISFY THEMSELVES AS TO THE NATURE AND SCOPE OF THE WORK. THE BASE PROPOSAL SHALL INCLUDE MODIFICATIONS TO SYSTEMS AND DEVICES AS REQUIRED BY STATE AND LOCAL CODES WHETHER INDICATED OR NOT ON CONTRACT DOCUMENTS. THE SUBMISSIONS OF A PROPOSAL WILL BE EVIDENCE THAT SUCH AN EXAMINATION AND COMPLIANCE WITH GOVERNING CODES/REQUIREMENTS HAS BEEN MADE. LATER CLAIMS FOR LABOR, EQUIPMENT, OR MATERIALS REQUIRED, OR FOR DIFFICULTIES ENCOUNTERED WHICH COULD HAVE BEEN FORESEEN HAD AN EXAMINATION AND CODE/REQUIREMENTS REVIEW BEEN MADE, WILL NOT BE ACCEPTED.

**01 SITE PLAN - ELECTRICAL**  
SCALE: 1\"/>

**SECTION 16050 - BASIC MATERIALS AND METHODS**

- ENCASE ALL CONDUCTORS IN A CONTINUOUS RACEWAY SYSTEM. PROVIDE PULL AND JUNCTION BOXES AS REQUIRED BY THE NEC. SIZE ALL RACEWAY PER THE NEC WITH OVERSIZE CONDUITS AS INDICATED. PROVIDE MINIMUM 3/4\" CONDUIT FOR BRANCH CIRCUITS, UNLESS NOTED OTHERWISE.
- PROVIDE EMT FOR ALL CONDUCTORS UNLESS NOTED OTHERWISE. PROVIDE CONCRETE-TIGHT STEEL COMPRESSION OR STEEL SETSCREW TYPE FITTINGS, COUPLINGS AND BUSHINGS. CAST OR INDENTOR TYPE DEVICES ARE NOT ACCEPTABLE.
- PROVIDE RIGID STEEL GALVANIZED CONDUIT FOR EXTERIOR WORK.
- PVC CONDUIT MAY BE USED UNDERGROUND OR BELOW CONCRETE SLABS. PROVIDE COATED RIGID STEEL ELBOWS FOR ALL ELBOWS WHERE PVC IS USED.
- PROVIDE FLEXIBLE METAL CONDUIT FOR CONNECTIONS TO TRANSFORMERS, MOTORS AND OTHER VIBRATING PIECES OF EQUIPMENT. PROVIDE LIQUID-TIGHT CONDUIT FOR ALL CONNECTIONS IN DAMP OR WET LOCATIONS. PROVIDE GROUND TYPE FITTINGS AND GROUNDING CONDUCTOR INSIDE ALL FLEXIBLE CONDUIT. ADJUST CONDUIT SIZE IF REQUIRED.
- PROVIDE GALVANIZED CODE GAUGE STEEL JUNCTION AND PULL BOXES WITH SCREW ON COVERS OF TYPE, SHAPE AND SIZE REQUIRED TO SUIT EACH INSTALLATION. PROVIDE GASKETING IN DAMP AND DUSTY LOCATIONS. PROVIDE CAST BOXES IN WEATHERPROOF ENVIRONMENTS.
- PROVIDE WIRE AND CABLE WITH INSULATION VOLTAGE RATING EQUAL TO OR GREATER THAN THE APPLIED SYSTEM VOLTAGE. PROVIDE SOLID OR STRANDED COPPER CONDUCTORS WITH TYPE THWN, THHN, OR XHHN INSULATION FOR NO. 12 AWG AND NO. 10 AWG CONDUCTORS. PROVIDE STRANDED COPPER CONDUCTORS WITH TYPE THWN, THHN, OR XHHW INSULATION FOR NO. 8 AWG AND LARGER CONDUCTORS. PROVIDE MINIMUM NO. 12 AWG CONDUCTOR SIZE UNLESS NOTED OTHERWISE. USE THE MINIMUM CONDUCTOR SIZE WHEN NO SIZE IS INDICATED. ALL CONDUCTORS TO BE COLOR-CODED AS FOLLOWS: 277/480 VOLT SYSTEMS-PHASE A (BROWN), PHASE B (ORANGE), PHASE C (YELLOW), NEUTRAL (GRAY).
- PRIOR TO TURNING THE PROJECT OVER TO THE OWNER TURN ON ALL LIGHTING AND WITH A MULTIMETER, READ THE CURRENT DRAWN ON EACH HOT LEG OF FEEDER SUPPLYING EACH DISTRIBUTION PANEL. IF THE CURRENT IN ANY ONE LEG VARIES MORE THAN 5% (PLUS OR MINUS) FROM THE ARITHMETIC AVERAGE OF THE CURRENT IN ALL THE HOT LEGS, RECONNECT THE BRANCH CIRCUITS TO OBTAIN A BALANCED LOADING.

**SECTION 16500 - LIGHTING**

- COMPLY WITH NEC AS APPLICABLE TO THE INSTALLATION AND CONSTRUCTION OF LIGHT FIXTURES.
- PROVIDE LIGHT FIXTURES THAT ARE LISTED AND LABELED BY U.L. OR ANOTHER NATIONALLY RECOGNIZED TESTING LABORATORY FOR THE APPLICATION.
- PROVIDE LAMP BALLASTS THAT COMPLY WITH CERTIFIED BALLAST MANUFACTURERS ASSOCIATION STANDARDS AND CARRY THE CBM LABEL.
- COMPLY WITH ALL LOCAL, STATE AND FEDERAL ENERGY CODES.
- PROVIDE FIXTURES WITH LAMPS, FOR EACH OUTLET SHOWN ON THE DRAWINGS AND AS SPECIFIED HEREIN. SEE FIXTURES LIST ON THE PLAN.
- PROVIDE LAMPS AS NOTED IN LIGHT FIXTURE SCHEDULE
- SOLID STATE TYPE TIME SWITCHES.
  - PROVIDE SOLID STATE, PROGRAMMABLE 24 HOUR OR 7-DAY, ELECTRIC TIME SWITCH WITH FOUR (4) SPST CONTACT RATED 20A AT 277 VOLTS. PROVIDE LONG LIFE LITHIUM BATTERY BACKUP TO MAINTAIN TIME AND MEMORY SETTING DURING A POWER OUTAGE.
  - ACCEPTABLE MANUFACTURERS
    - PARAGON EC7000 SERIES
    - TORK MODEL D100 SERIES
    - PRE-APPROVED EQUAL

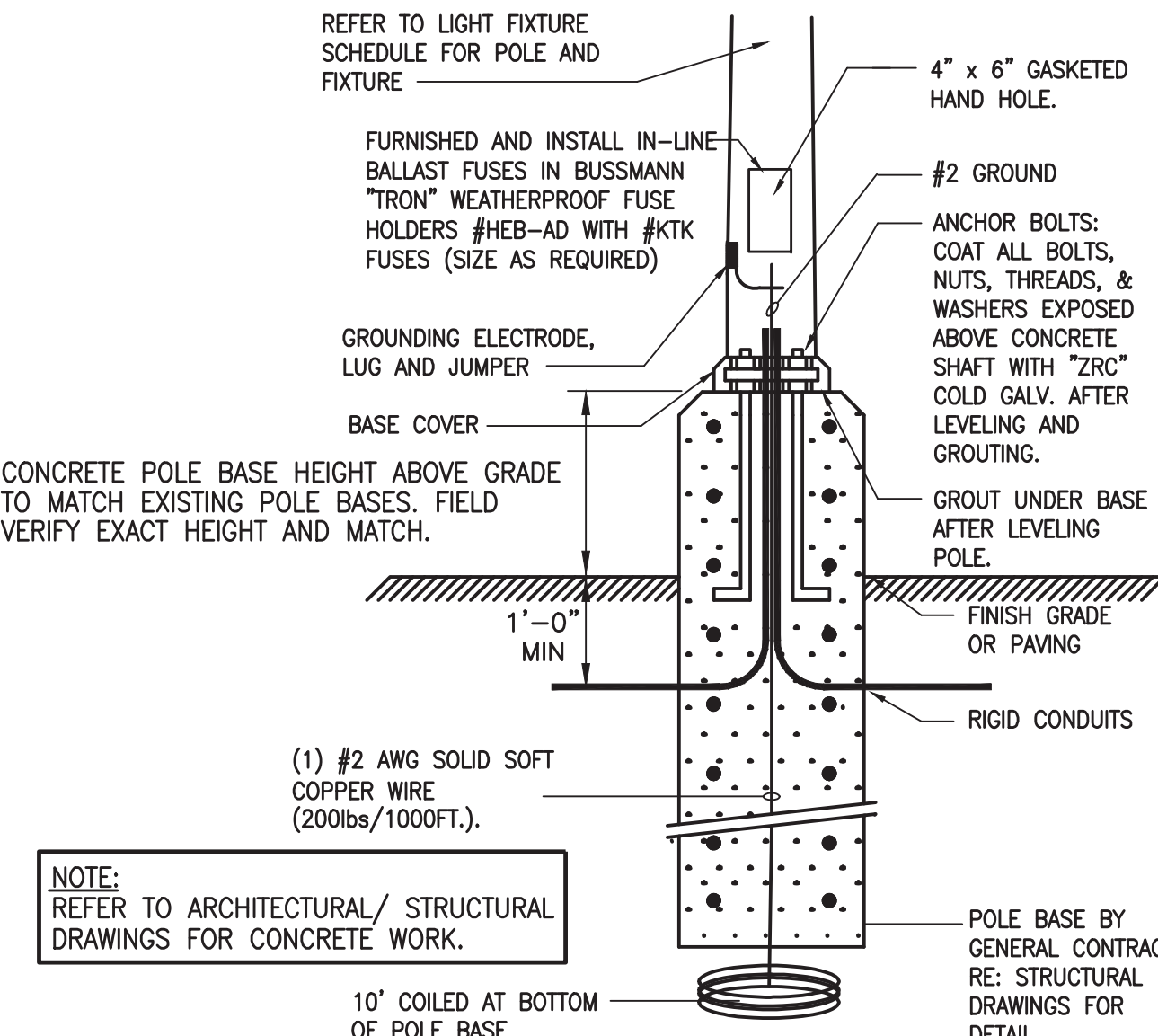

**2 ELECTRICAL REQUIREMENTS AT PARKING LOT AREA LIGHT 'S2A' POLE BASE**  
SCALE: N.T.S.

SITE IMPROVEMENT PACKAGE 06/07/11

ISSUED FOR CONSTRUCTION OCTOBER 8, 2014

**Hermes Architects**

Members A.I.A.  
1777 West Loop South, Ste. 500  
Houston, Texas 77027  
Tel: 713-785-3644  
www.hermesarchitects.com  
Houston • Dallas • Ft. Worth

06/07/11

KEITH W. GASSMAN  
88636  
REGISTERED PROFESSIONAL ENGINEER  
ELECTRICAL

**Crossroads**  
GREENVILLE PROPERTIES, LTD.  
1880 WILCHIRE BLVD.  
SUITE 1050  
LOS ANGELES, CA 90024

6834 WESLEY STREET  
GREENVILLE, TEXAS 75401

DATE: June 16, 2011  
PROJECT NO.: 809501  
DRAWN BY:  
CHECKED BY:

**AKME**  
KALMANS MARSHALL ENGINEERING, INC.  
HOUSTON | DALLAS, FT. WORTH | BATON ROUGE  
1425 Greenway Drive, Suite 440  
Irving, TX 75038 (972) 812-1270  
REGISTRATION # F-4111  
RME PROJECT # 0301003

**24 OF 24**

COPYRIGHT © 2011 Hermes Architects, Inc.