



Hermes Architec

Members A.L.A.
 1177 West Loop South, Ste. 500
 Houston, Texas 77027
 Tel. 713-785-3644
 www.hermesarchitects.com
 Houston • Dallas • Ft. Worth

This document is an instrument of service protected by the copyright law of the United States of America, 17 U.S.C. § 102, and shall not be copied or reproduced without the express written consent of Hermes Architects, Inc.

CROSSROADS MALL RENOVATION
 6534 WESLEY STREET
 GREENVILLE, TEXAS 75401

Crossroads
 GREENVILLE PROPERTIES LTD.

DATE: June 16, 2011
 PROJECT NO.: 809501
 DRAWN BY:
 CHECKED BY:

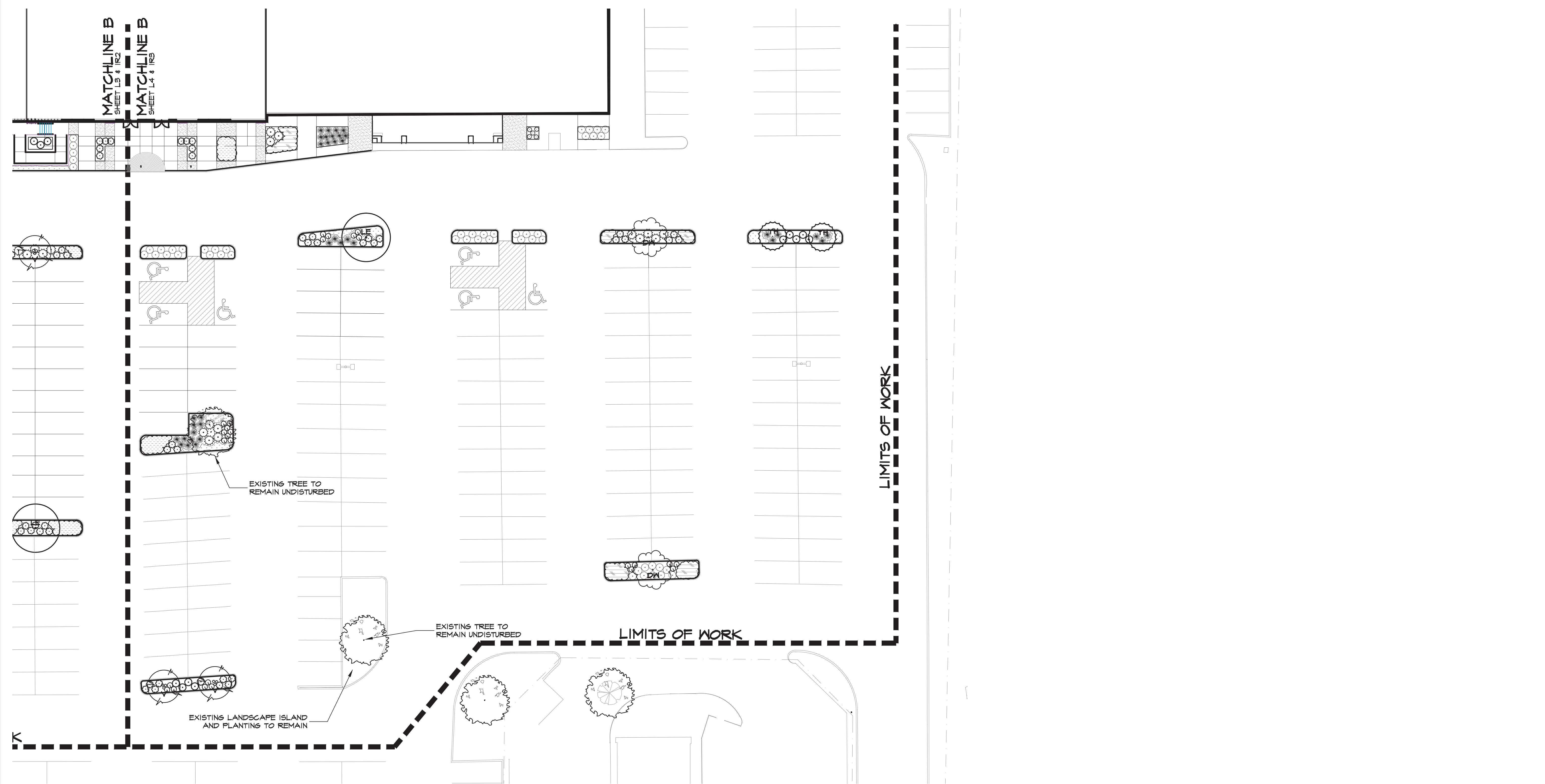

LANDSCAPE LEGEND

- | | | |
|--|--|---|
| EXISTING LANDSCAPE ISLAND TREE TO REMAIN UNDISTURBED | VITEX TREE / VITEX AGNUS-CASTUS (3" GALIFER) | DWARF FOUNTAIN GRASS / FENISTEM ALOPEGUROIDES 'HAMELI' (2 GALLON, PLANTS SPACED 24" O.C.) |
| LACEBARK ELM / ULMUS PARVIFOLIA (3" GALIFER) | FRINGE FLOWER / LOROPETALUM CHINENSE (3 GALLON) | BLUE PACIFIC JUNIPER / JUNIPERUS HORIZONTALIS (3 GALLON, PLANTS SPACED 36" O.C.) |
| DESERT WILLOW / CHILOPSIS LINEARIS (3" GALIFER) | RED YUGGA / HESPERALOE PARVIFLORA (5 GALLON) | MEXICAN FEATHER GRASS / STIPA TENNISSIMA (1 GALLON, PLANTS SPACED 12" O.C.) |
| YAUPON HOLLY / ILEX VOMITORIA (3" GALIFER) | DWARF MAIDEN GRASS / MISCANTHUS SINENSIS 'ADAGIO' (3 GALLON) | |
| | KNOCKOUT ROSE / ROSA SPP. (3 GALLON) | |
| | DWARF YAUPON HOLLY / ILEX VOMITORIA 'NANA' (3 GALLON) | |
| | NDJIAN HAWTHORN 'SNOW' / RAPHILOPSIS UMBELLATA 'SNOW WHITE' (3 GALLON) | |
| | AFRICAN IRIS / DIETES IRIDIODES (3 GALLON) | |

LANDSCAPE NOTES

- ALL SIZES OF PLANT MATERIAL CALLED OUT IN LANDSCAPE LEGEND TO BE THE SIZE OF PLANT MATERIAL AT TIME OF PLANTING.
- ALL REQUIRED LANDSCAPE AREAS SHALL BE PROVIDED WITH AN AUTOMATIC UNDERGROUND IRRIGATION SYSTEM WITH RAIN AND FREEZE SENSORS AND EVAPOTRANSPIRATION (ET) WEATHER BASED CONTROLLER AND SAID IRRIGATION SYSTEM SHALL BE DESIGNED BY A QUALIFIED PROFESSIONAL AND INSTALLED BY A LICENSED IRRIGATOR.
- ALL LANDSCAPE BEDS IN THE PARKING LOT SHALL BE SURROUNDED BY A 6" CONCRETE CURB, REFER TO ARCH. SITE PLAN TO CONFIRM. SAID LANDSCAPE BEDS SHALL SLOPE TO DRAIN TOWARDS THE PARKING LOT AT MINIMAL SLOPE.
- ALL LANDSCAPE BEDS AT THE ENTRANCE OF THE MALL SHALL SLOPE TO DRAIN TOWARDS THE PARKING LOT, AND SHALL NOT IMPEDE STORM WATER CIRCULATION AS DESIGNED BY OTHER TRADES.
- UNLESS NOTED ON DEMOLITION PLANS, ALL EXISTING PLANTING BEDS AND TREES ARE TO BE PRESERVED. CONTRACTOR SHALL PROVIDE NECESSARY MEANS OF PROTECTIVE FENCING FOR PRESERVATION OF ALL TREES AND SHRUBS. THE CONTRACTOR SHALL BE RESPONSIBLE FOR REPAIRING ANY DAMAGES TREES, SHRUBS, AND GROUND COVER THAT ARE SHOWN TO REMAIN.