

THIS SHEET IS FOR INFORMATION ONLY AND DESIGNATES THE SCOPE OF WORK TO BE DONE.

DEMOLITION FLOOR PLAN
 1
 A2-1 SCALE: 1" = 28'-0"

DEMOLITION LEGEND:

	INDICATES EXISTING WALL CONSTRUCTION TO BE REMOVED
	INDICATES DOORS TO BE REMOVED
	INDICATES AREA OF REMOVED SLAB

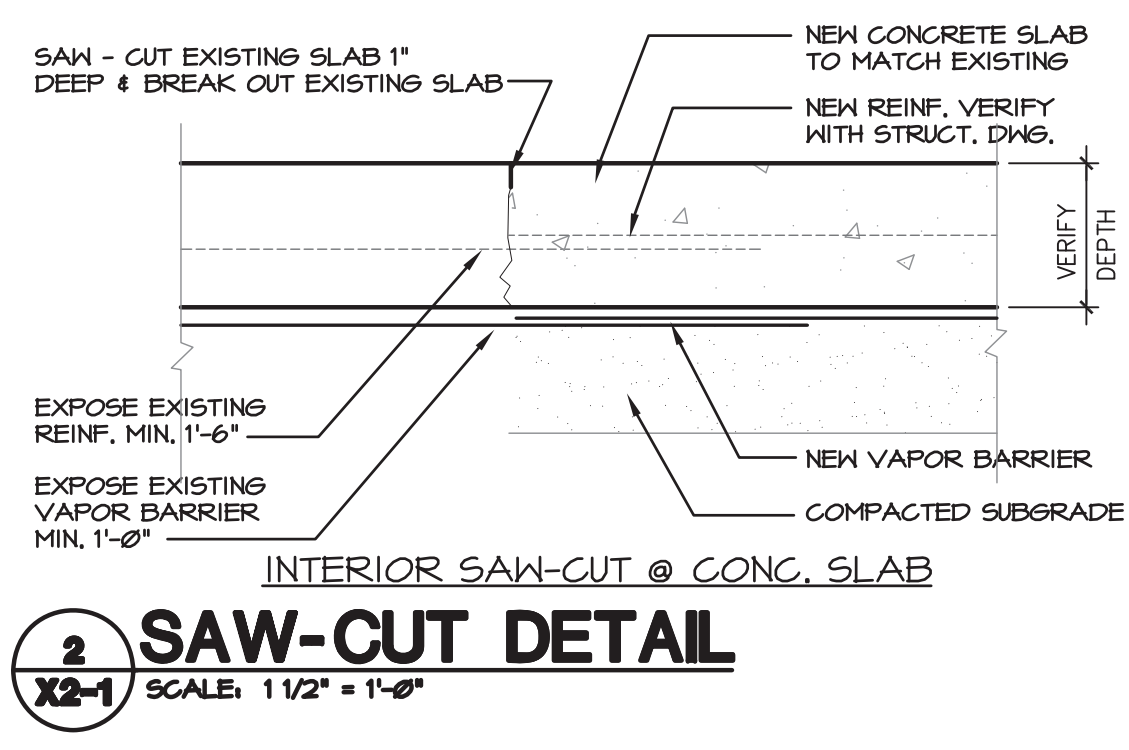

- DEMOLITION NOTES:**
1. THE ARCHITECT AND ARCHITECTS' CONSULTANTS SHALL NOT HAVE CONTROL, OVER OR CHARGE OF, OR DISPOSAL OF, OR EXPOSURE OF PERSONS TO, HAZARDOUS MATERIALS IN ANY FORM AT THE PROJECT SITE, INCLUDING, BUT NOT LIMITED TO, HAZARDOUS MATERIAL PRODUCT POLYCHLORINATED BIPHENYL (PCB), OR OTHER SUBSTANCES.
 2. THE ARCHITECT AND ARCHITECTS' CONSULTANTS SHALL NOT HAVE CONTROL, OVER OR CHARGE OF, OR DISPOSAL OF, OR EXPOSURE OF PERSONS TO, HAZARDOUS MATERIALS IN ANY FORM AT THE PROJECT SITE, INCLUDING, BUT NOT LIMITED TO, HAZARDOUS MATERIAL PRODUCT POLYCHLORINATED BIPHENYL (PCB), OR OTHER SUBSTANCES.

- DEMOLITION NOTES:**
1. HAZARDOUS MATERIAL MAY BE FOUND AND THE GENERAL CONTRACTOR IS TO NOTIFY THE OWNER IMMEDIATELY. HAZARDOUS MATERIAL ABATEMENT IS NOT PART OF THE CONTRACT. REMOVAL OF ANY HAZARDOUS MATERIAL SHALL BE THE RESPONSIBILITY OF THE BUILDING OWNER. THE CONTRACTOR IS HEREBY CAUTIONED THAT THE CUTTING AND/OR REMOVAL OF THIS MATERIAL MAY REQUIRE SPECIAL CARE AND HANDLING. THE CONTRACTOR SHALL BE RESPONSIBLE FOR CONFORMANCE TO ALL APPLICABLE LOCAL, STATE, AND FEDERAL LAWS AND REGULATIONS REGARDING THIS MATERIAL.
 2. CLEAN ALL DEBRIS AND UNUSED EQUIPMENT OFF OF ROOF AND REFER TO THE ROOF PLAN FOR ADDITIONAL DEMOLITION WORK REQUIRED.
 3. WHERE THE SLAB HAS BEEN REMOVED FOR INSTALLATION OF NEW SEWER LINES, REPLACE SLAB TO MATCH EXISTING.
 4. ABANDON AND CAP ALL UTILITY SERVICES TO BE REMOVED PLUMBING FIXTURES AS PER PLUMBING DRAWINGS.
 5. ALL DEMOLITION WORK AND TEMPORARY CONSTRUCTION SHALL BE DONE IN THE SAFEST POSSIBLE MANNER AND IN CONFORMANCE WITH ALL GOVERNMENTAL AUTHORITIES' REGULATIONS FOR HEALTH AND SAFETY.

6. REMOVE ALL FLOOR DRAINS THAT WILL BE DEMOLISHED AND NEW DRAIN OPENINGS 12" BELOW FINISH FLOOR SURFACE. PROVIDE A SMOOTH SURFACE FLUSH WITH FINISH FLOOR IN AREA WHERE EXISTING FLOOR SLOPES TO DRAIN. COORDINATE WITH OTHER SLAB WORK.
7. GRIND SMOOTH ANY IMPERFECTIONS IN CONCRETE SLAB AS A RESULT OF PREVIOUS OR NEW DEMO WORK TO BRING SLAB INTO TOLERANCES AS PER PROJECT MANUAL.
8. REFER TO MEP DRAWINGS FOR INFORMATION RELATED TO DEMOLITION OR RELOCATION OF ANY MECHANICAL, ELECTRICAL, AND PLUMBING ITEMS NOT FULLY ADDRESSED ON THIS SHEET INCLUDING, BUT NOT LIMITED TO, LIGHTING, PLUMBING FIXTURES, AND DUCTWORK. REMOVE ALL MECHANICAL, ELECTRICAL, AND PLUMBING ITEMS UNLESS OTHERWISE NOTED ON MEP DRAWINGS.
9. NOTIFY ARCHITECT IF ANY UNDER FLOOR CONDUIT IS FOUND WHEN REMOVING THE EXISTING FLOOR SLAB.
10. COORDINATE ALL DEMOLITION ACTIVITIES WITH THE BUILDING OWNER.

11. SEE STRUCTURAL DRAWINGS FOR DEMOLITION WORK RELATED TO NEW FOOTINGS.
12. THE DEMOLITION CONTRACTOR IS TO OBTAIN AND PAY FOR ALL PERMITS NECESSARY TO PERFORM DEMOLITION WORK.
13. WHERE EXISTING FLOOR SLAB IS TO BE REMOVED SAW CUT EXISTING FLOOR SLAB TO LIMITS INDICATED ON THIS PLAN AND ON MEP DRAWINGS, TO A DEPTH OF NOT LESS THAN 2 INCHES. BREAK OUT REMAINING CONCRETE. EXPOSE 10-INCHES OF EXISTING REINFORCING. CUT REINFORCING CLEANLY SUCH THAT THE REINFORCING IS LEFT IN PLACE WITH THE PAVEMENT TO REMAIN. BEND STEEL OUT OF THE WAY. REMOVE AND DISPOSE OF THE EXISTING FLOOR SLAB AS REQUIRED.

NOTE:
 REVISED TITLE BLOCK TO CORRECT CLIENT INFORMATION
 (9.17.13)

Hermes Architects
 Members A.I.A.
 1177 West Loop South, Ste. 500
 Houston, Texas 77027
 Tel. 713-765-3644
 www.hermesarchitects.com
 Houston • Dallas • Ft. Worth

CROSSROADS MALL RENOVATION
 GREENVILLE, TEXAS

GREENVILLE PROPERTIES, LTD.
 10850 WILCHIRE BLVD.
 SUITE 1050
 LOS ANGELES, CA 90024

DATE: May 10, 2011
 PROJECT NO.: 809501
 DRAWN BY: ---
 CHECKED BY: ---

DEMOLITION FLOOR PLAN

X2-1

K:\809501\DRAWINGS\4-1 PLOT SHEETS\SHEETS\X2-1 DEMOLITION FLOOR PLAN.DWG 5/10/2011 2:47:06 PM RALPH WINDLE