

PLANT MATERIAL LIST

ID	BOTANICAL NAME	COMMON NAME	SIZE	QTY	ROOT
AF	ACER FREMANII x 'JEFFERSRED'	AUTUMN BLAZE MAPLE	2 1/2" CAL	7	B & B
CV	CRATAEGUS VIRIDIS 'WINTER KING'	WINTER KING HAWTHORN	1 1/2" CAL	X	B & B
RA	RHUS AROMATICA 'GRO-LOW'	GRO-LOW SUMAC	24" SPRD	X	3 GAL
PA	PENNISETUM ALOPECUROIDES 'HAEMEL'	FOUNTAIN GRASS	#1 CONT	X	1 GAL

- SEEDED TURF
- GRAVEL MULCH

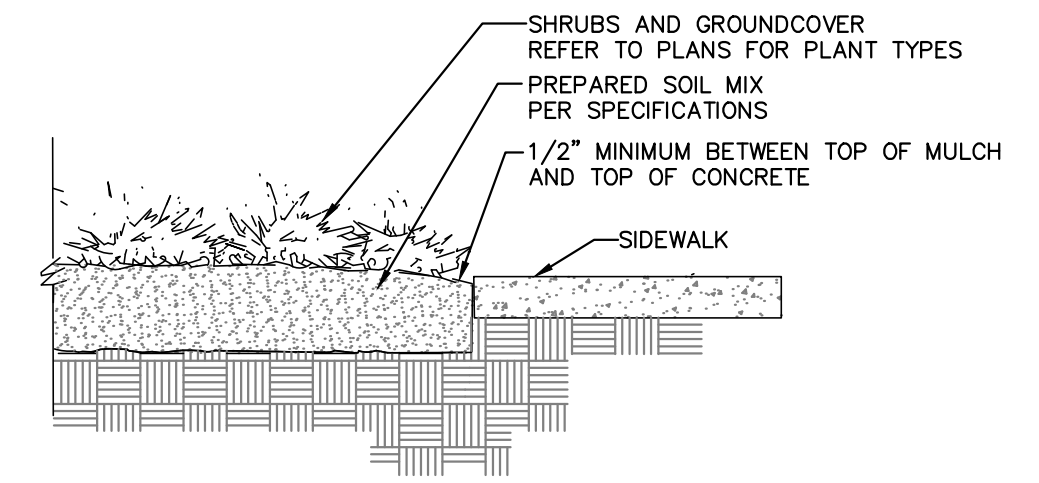

SIDEWALK/MULCH DETAIL 1
NOT TO SCALE 501

- NOTES:
- DO NOT PRUNE EVERGREENS, EXCEPT TO REMOVE DEAD AND BROKEN BRANCHES.
 - THIN BRANCHES AND FOLIAGE (NOT ALL BRANCH TIPS) BY 1/3, RETAINING NORMAL PLANT SHAPE (EXCEPT EVERGREEN).
 - REMOVE BURLAP FROM TOP 1/3 OF BALL OR WITH CONTAINER PLANTS, REMOVE POTS AND SPLIT BALLS AS SPECIFIED.

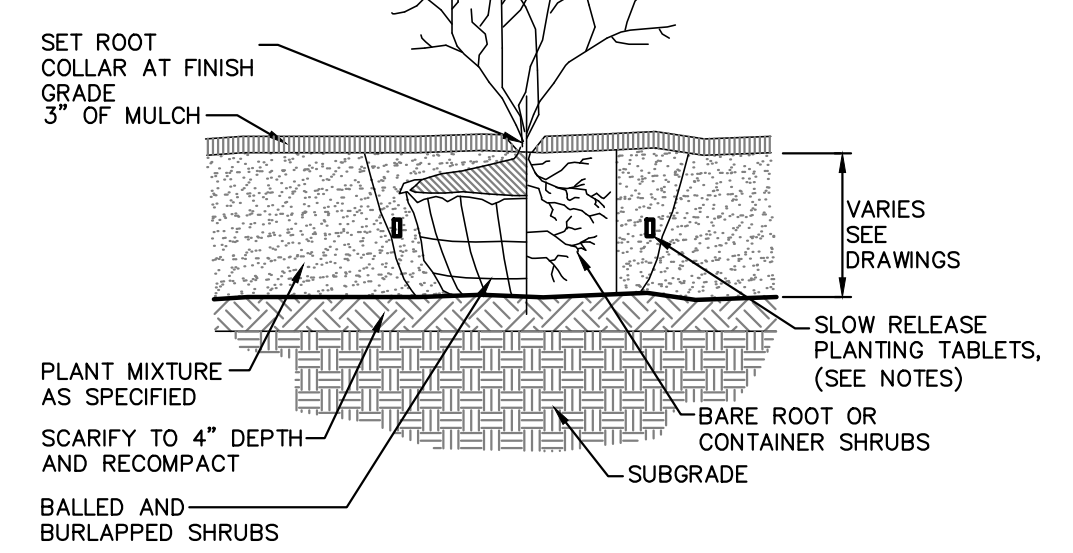

SHRUB PLANTING DETAIL 2
NOT TO SCALE 501

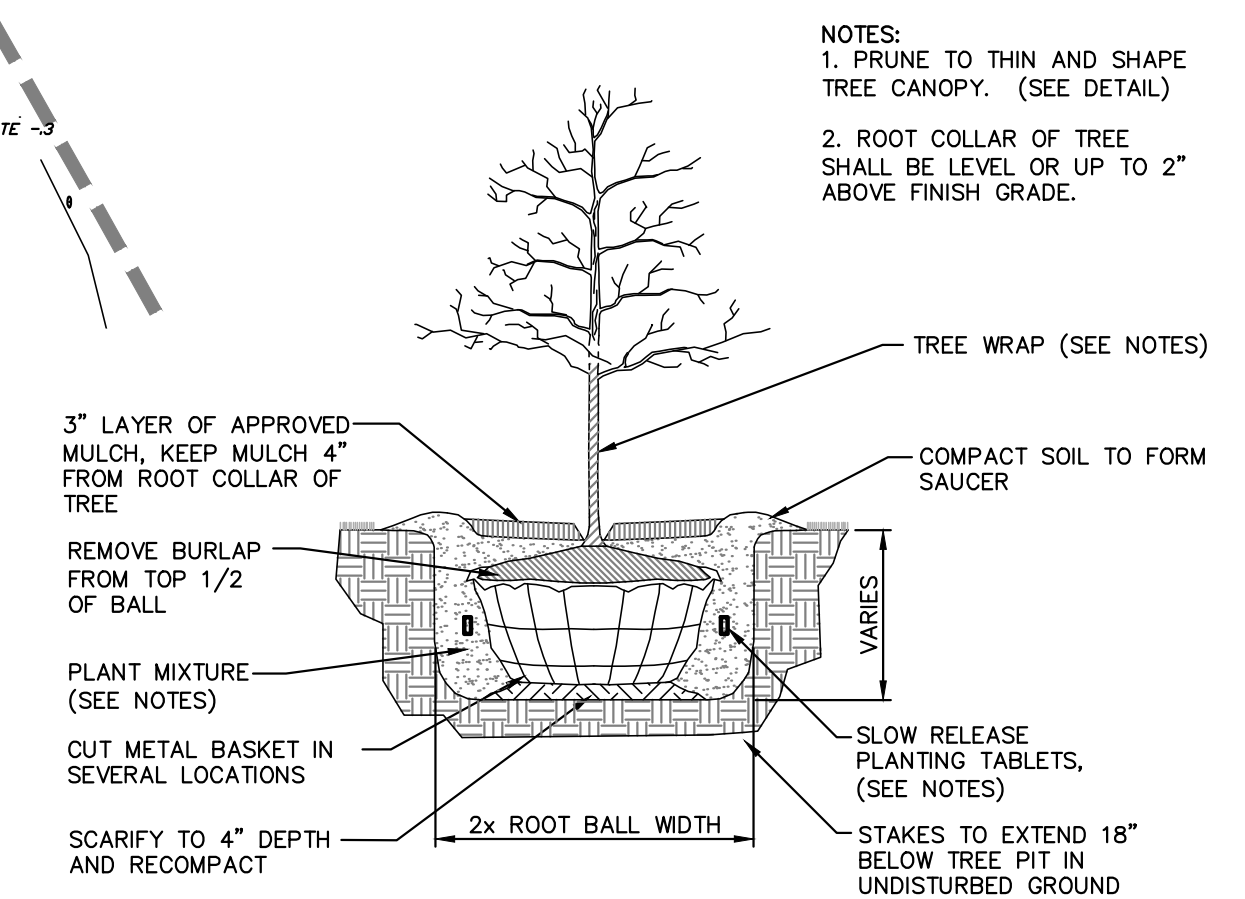

TREE PLANTING DETAIL 3
NOT TO SCALE 501

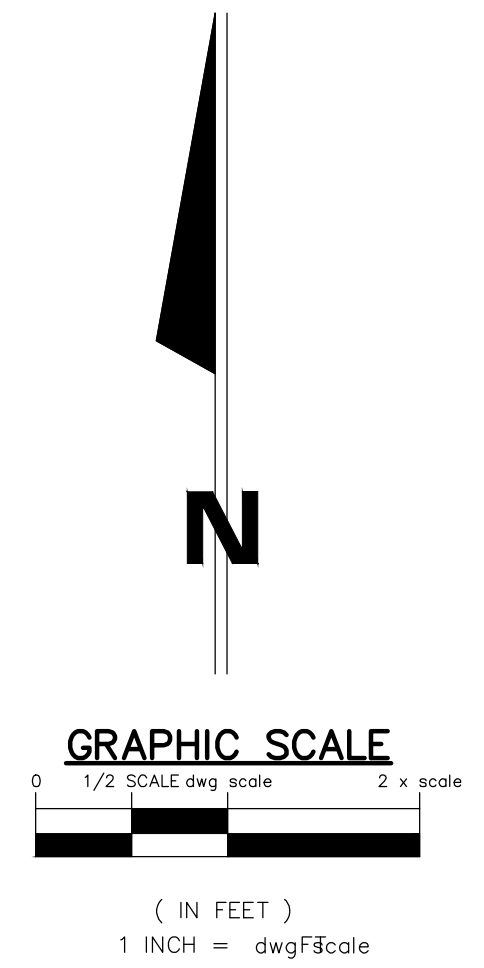

211 S. Concord Mall Dr.
PROPOSED/EXISTING BUILDING
50,617 SFT
FFE = 756.60
REFER TO ARCHITECTURAL PLANS
FOR BUILDING DETAILS

	DATE BY DESCRIPTION REV.
PRELIMINARY FOR REVIEW PURPOSES ONLY	
SHOPS ON CONCORD TRYAR COMPANIES, INC.	From Wynns, Indiana p. 269.42.2332 South Bend, Indiana p. 574.232.4188 Elkhart, Indiana p. 574.293.7762
10850 WILSHIRE BOULEVARD, SUITE 1250 LOS ANGELES, CA 90024 SITE LANDSCAPE PLAN & DETAILS	
DESIGNED BY: CHRIS CHOCKLEY	
DRAWN BY: MMS, ARB	
DATE: JANUARY 2017	
JOB NUMBER: 2016-0160	
SCALE: 1"=30'	
C-601	

CA 2016 Projects 2016-0160 ENG/Martin's, Bluff/C-601-LANDSCAPE.DWG, 1/13/2017 4:20:00 PM